

Wood Thoro-Hung Ovolo Arch High Impact Opaque Single Door (NTCL-210-4190-11 & NCTL-210-4190-14)

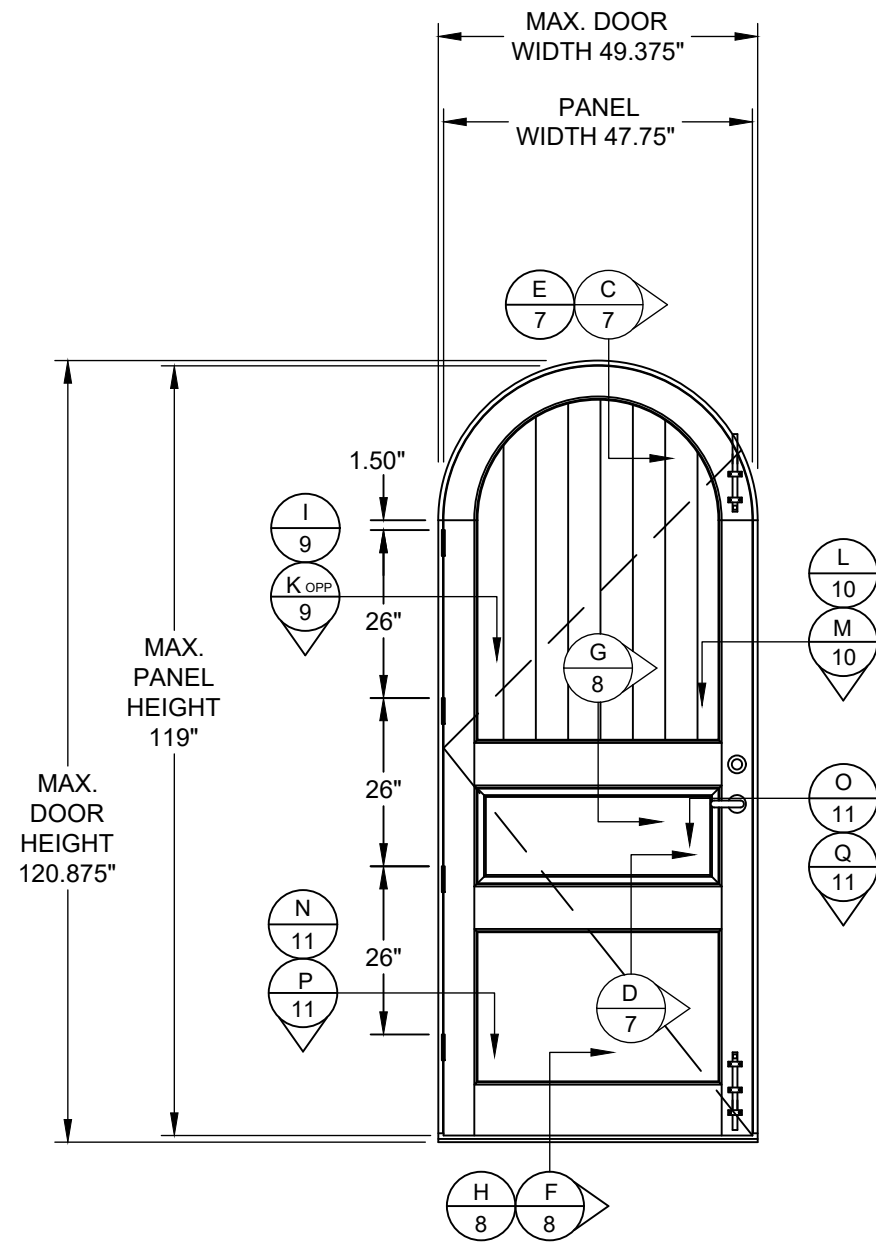

ELEVATION 1
INTERIOR VIEW

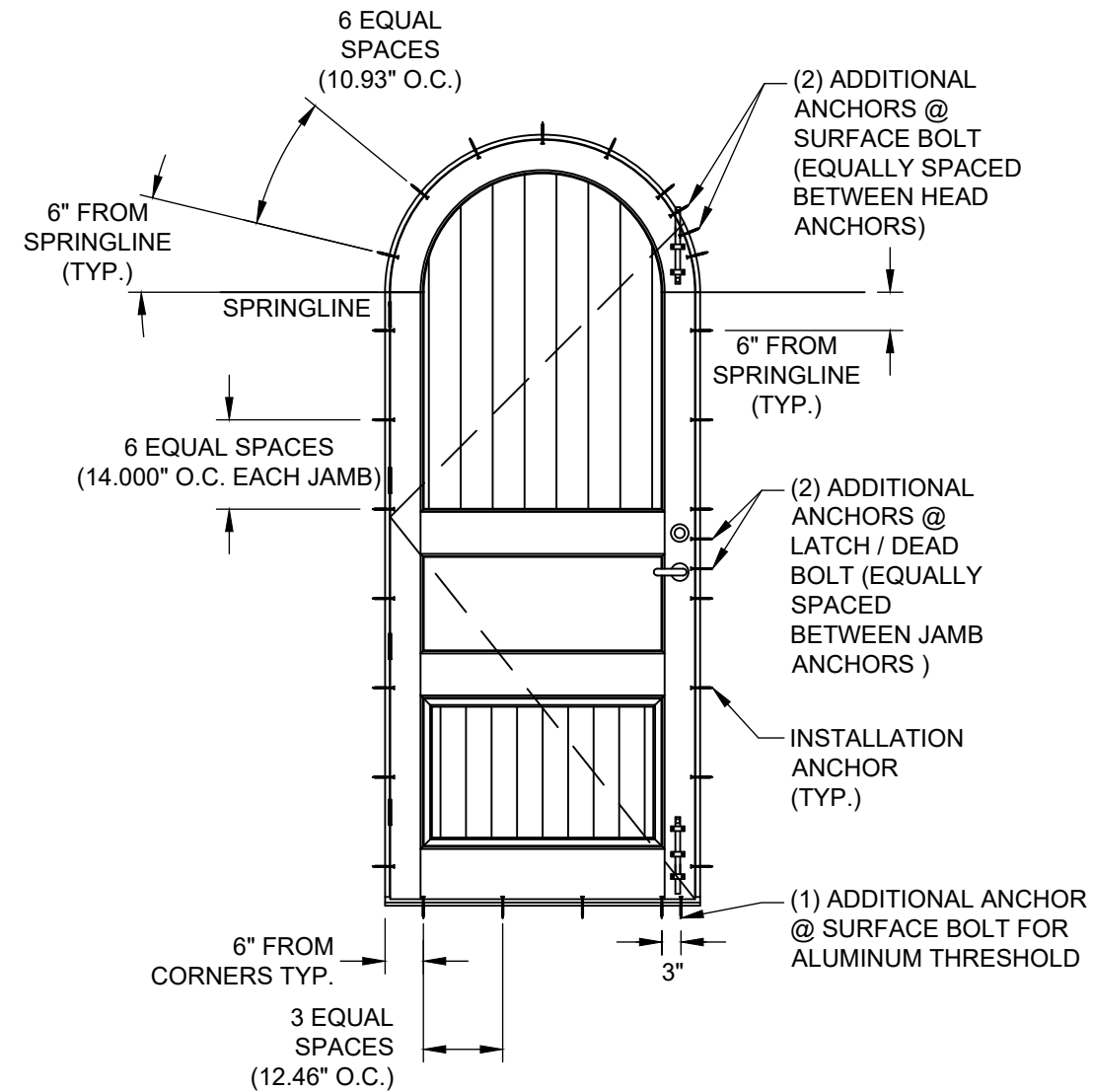

ANCHOR LAYOUT 1
INTERIOR VIEW

(NOTE: NO INSTALLATION ANCHORS TO BE LOCATED CLOSER THAN 3" O.C.)

PROJECT NO. 421-0102

<p>SIMPSON DOOR COMPANY 400 SIMPSON AVE. MCCLEARY, WA 98557</p>	<p>IMPACT 10 FT. OPAQUE WOOD ENTRY DOOR ELEVATION AND ANCHOR LAYOUT</p>	<p>DATE: 6/15/21 DRAWING NO: SIMP0019 SHEET: 2 OF 12</p>	
<p>PREPARED BY: RJA SCALE: N.T.S. REV: ---</p>	<p>DRAWN BY: RJA DATE: 6/15/21</p>	<p>DATE: 6/15/21 DRAWING NO: SIMP0019 SHEET: 2 OF 12</p>	<p>REV: --- DESCRIPTION DATE BY</p>

Robert J. Amoruso, P.E.
Florida P.E. No. 49752

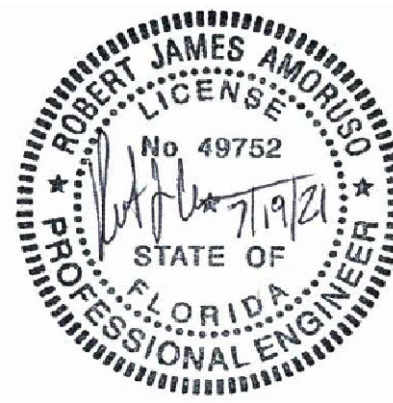

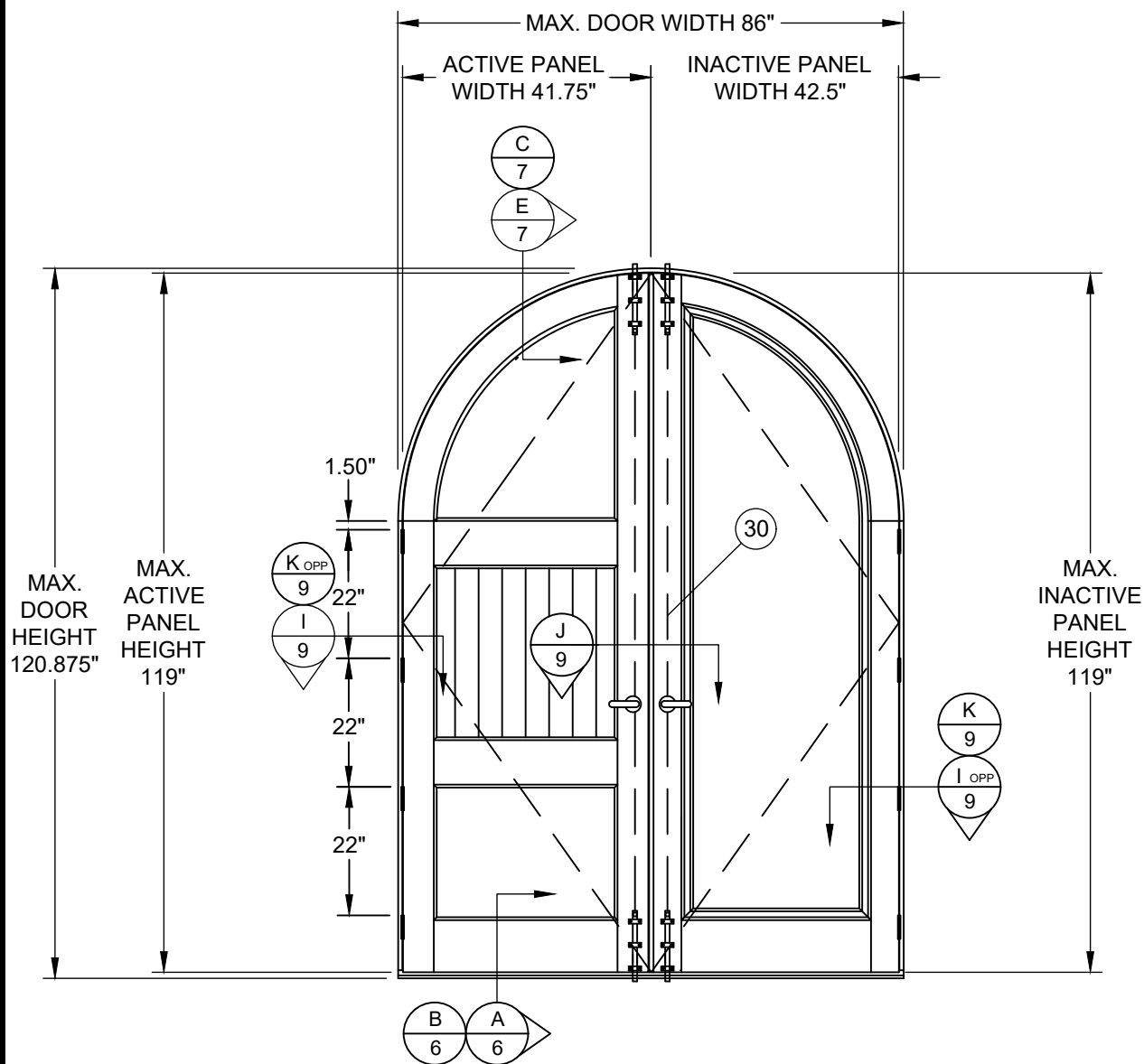

ELEVATION 2
INTERIOR VIEW

**Wood Thoro-Hung Shaker/Westar High Impact
Round-Top Opaque Double Door
(NCTL-210-4190-11 & NCTL-210-4190-13)**

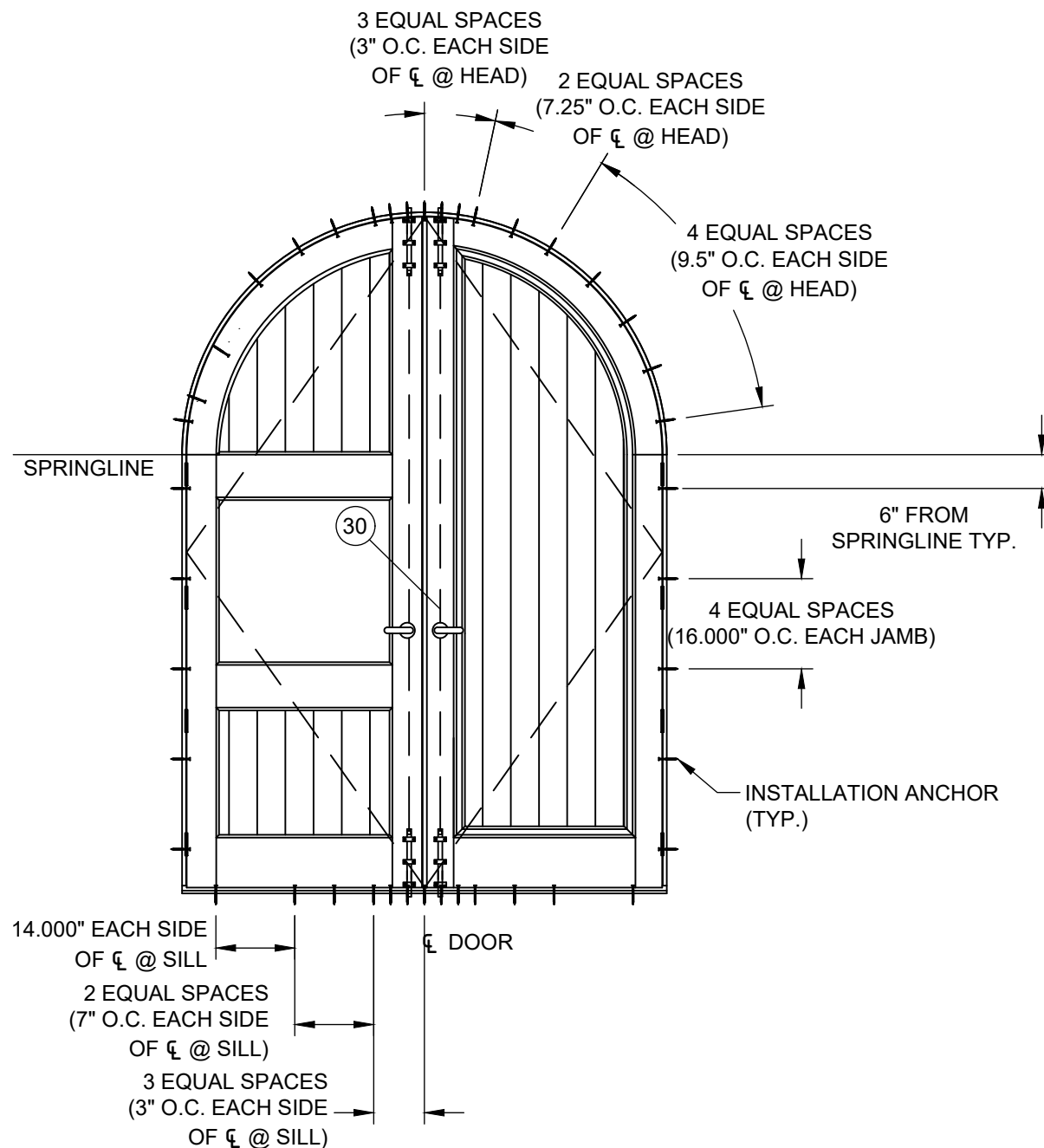

ANCHOR LAYOUT 2

INTERIOR VIEW
(NOTE: NO INSTALLATION ANCHORS TO BE LOCATED CLOSER THAN 3" O.C.)

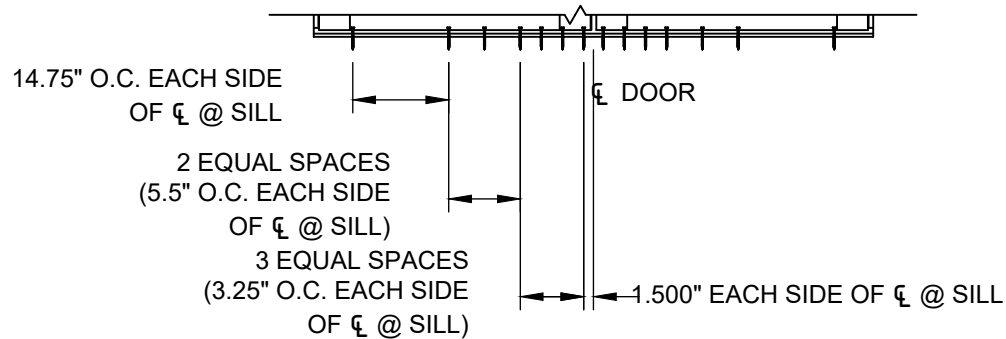

ANCHOR LAYOUT 2
FOR ALUMINUM THRESHOLD

PROJECT NO. 421-0102

SIMPSON DOOR COMPANY
400 SIMPSON AVE.
MCCLEARY, WA 98557

TITLE: IMPACT 10 FT. OPAQUE WOOD ENTRY DOOR ELEVATION AND ANCHOR LAYOUT

PREPARED BY: RJA
DRAWN BY: RJA
DATE: 6/15/21
SCALE: N.T.S.
DRAWING NO: SIMP0019
REV: ---
SHEET: 3 OF 12

PTC Product Design Group, LLC
Longwood, FL 32752-0775
Phone: 321.680.1788
Fax: 321.680.1769
Email: info@pdc-corp.com
FBPE C.A. NO. 25835

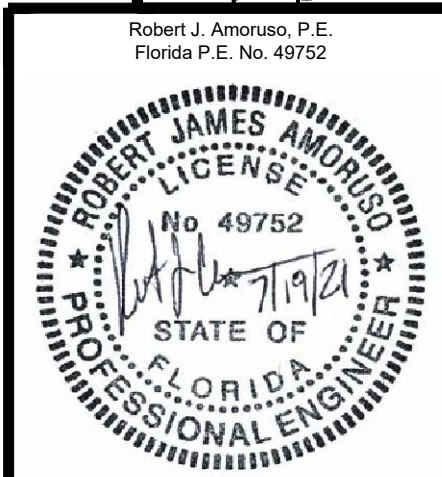

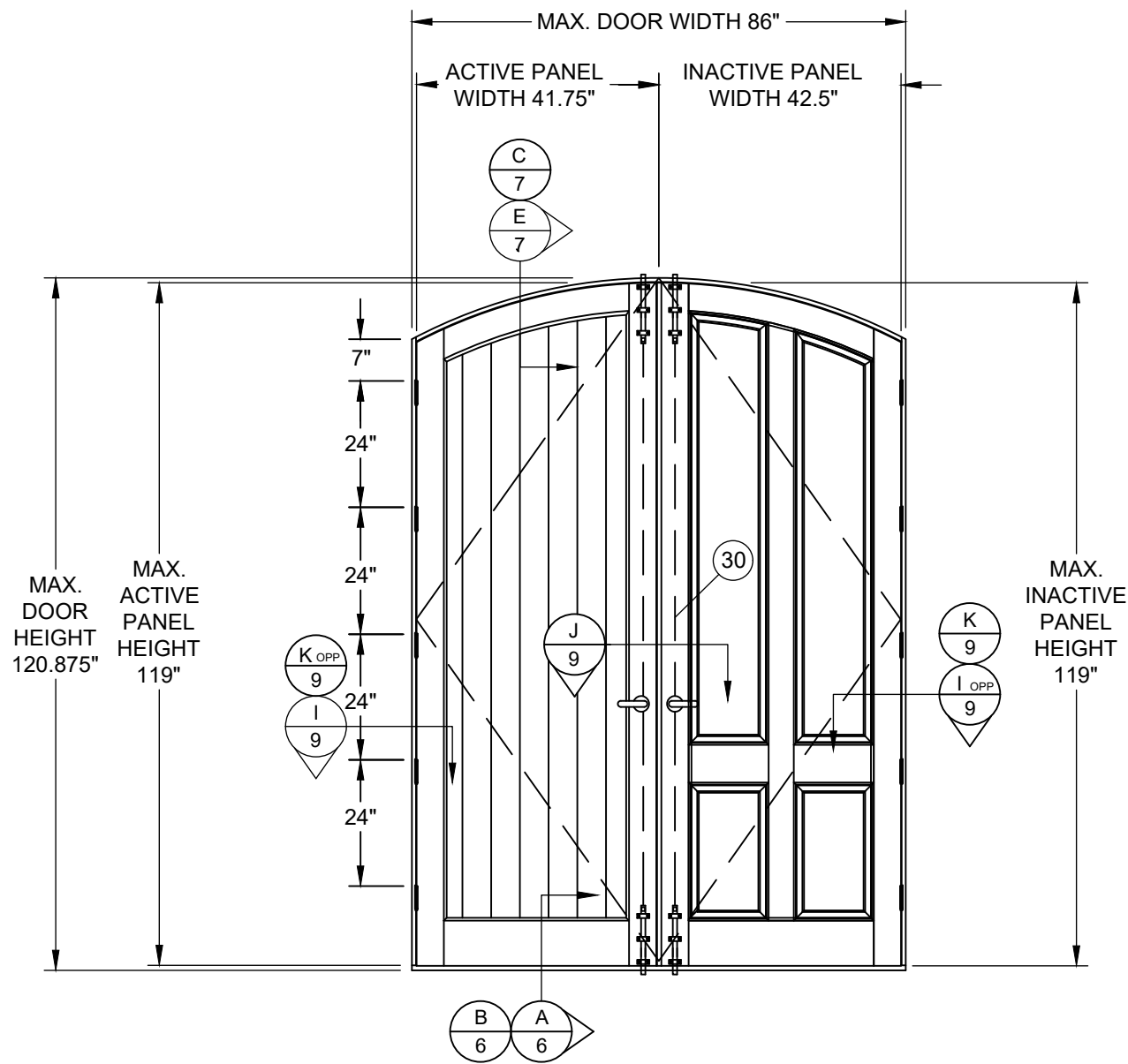

ELEVATION 3
INTERIOR VIEW

**Wood Thoro-Hung Westar Arch-Top High Impact
Opaque Double Door**
(NTCL-210-3260-3, NCTL-210-4190-11 & NCTL-210-4190-12)

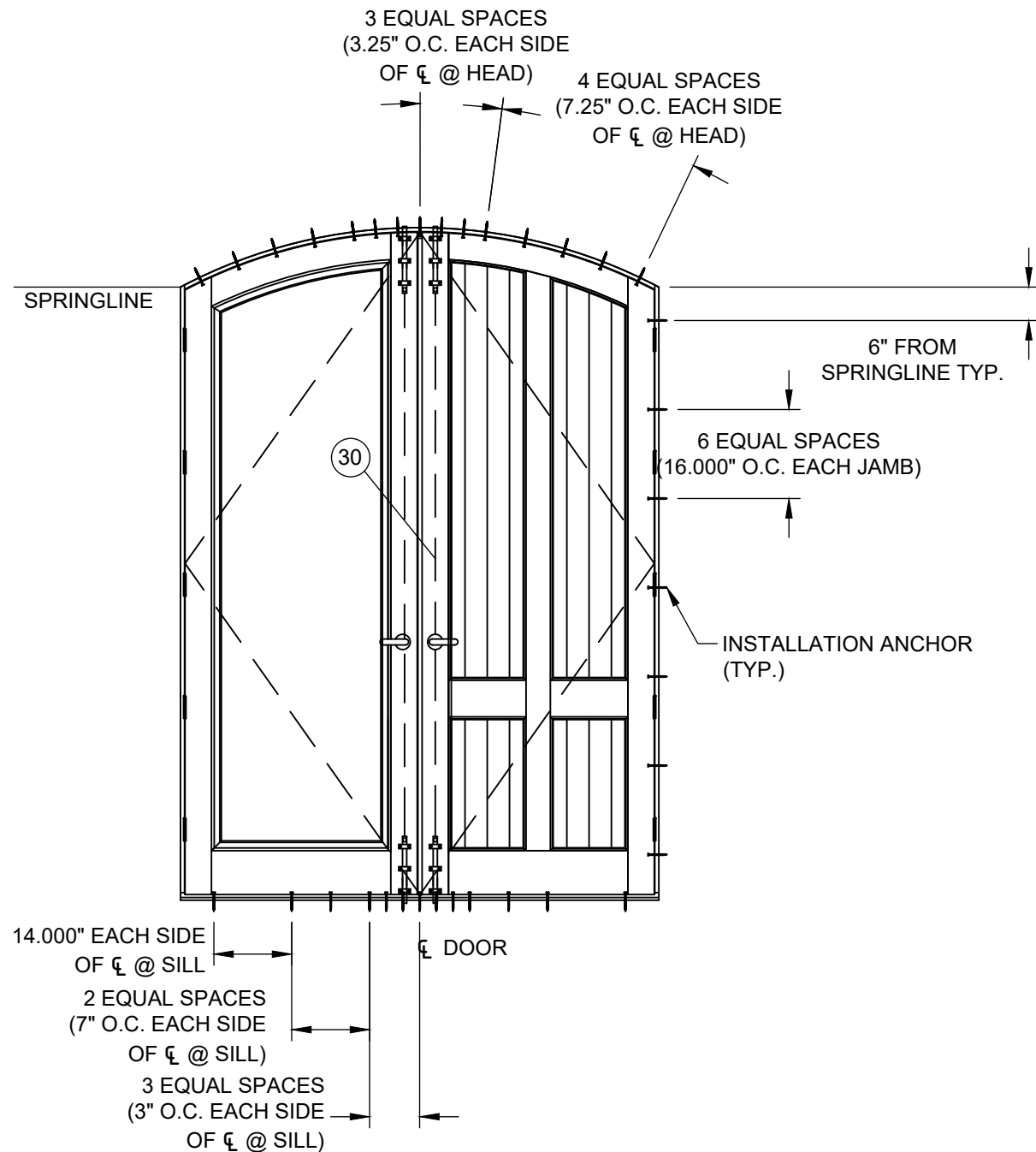

ANCHOR LAYOUT 3
INTERIOR VIEW
(NOTE: NO INSTALLATION ANCHORS
TO BE LOCATED CLOSER THAN 3" O.C.)

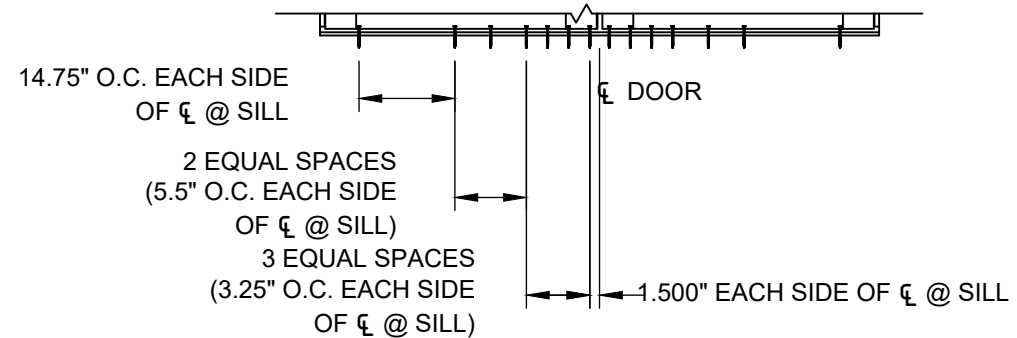

ANCHOR LAYOUT 3
FOR ALUMINUM THRESHOLD

PROJECT NO. 421-0102

SIMPSON DOOR COMPANY
400 SIMPSON AVE.
MCCLEARY, WA 98557

TITLE: IMPACT 10 FT. OPAQUE WOOD ENTRY DOOR
ELEVATION AND ANCHOR LAYOUT

PREPARED BY: RJA
SCALE: N.T.S.
DATE: 6/15/21
DRAWING NO: SIMP0019
SHEET: 4 OF 12

PTC Product Design Group, LLC
PO Box 320775
Lynchburg, VA 24032-0775
Phone: 321.690.1788
Fax: 321.690.1789
Email: info@ptc-corp.com
FBPE C.A. NO. 25535

Robert J. Amoruso, P.E.
Florida P.E. No. 49752



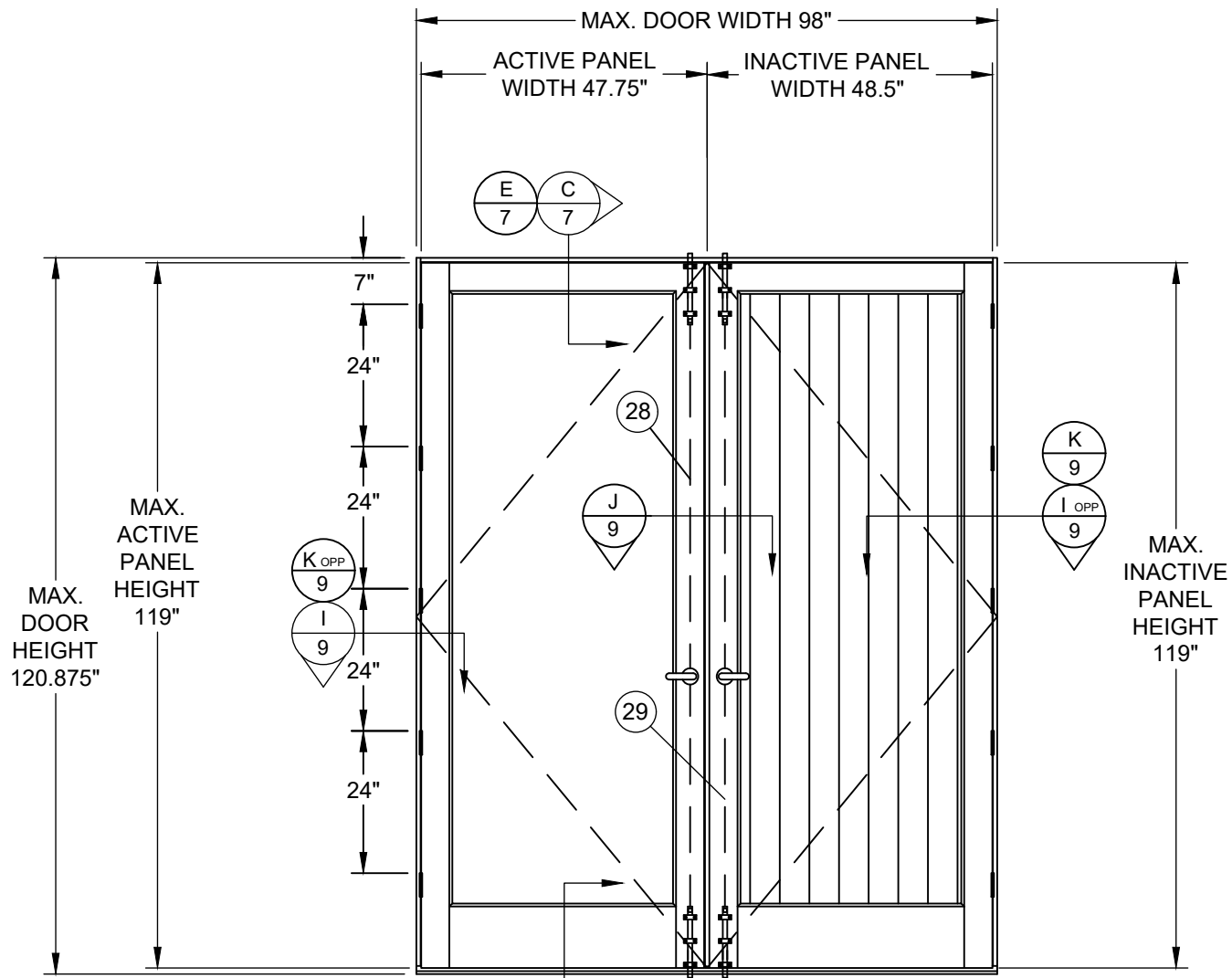

ELEVATION 4
 INTERIOR

**Wood Thoro-Hung Westar High Impact Opaque
 Double Outswing Door**
 (NCTL-210-4190-11 & NCTL-210-4190-12)

**Wood Thoro-Hung Westar Opaque Double
 Outswing Door**
 (NCTL-210-4190-11 & NCTL-210-4190-15)

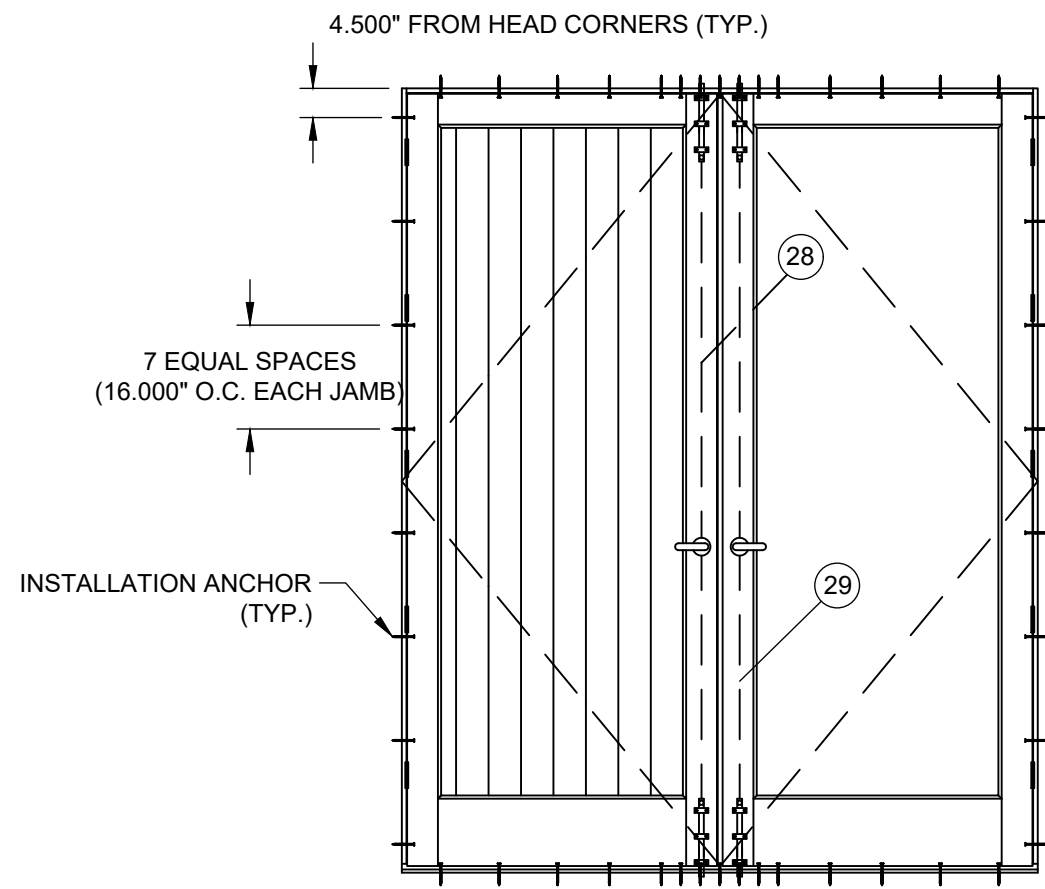

ANCHOR LAYOUT 4

INTERIOR
 (NOTE: NO INSTALLATION ANCHORS TO BE LOCATED CLOSER THAN 3" O.C.)

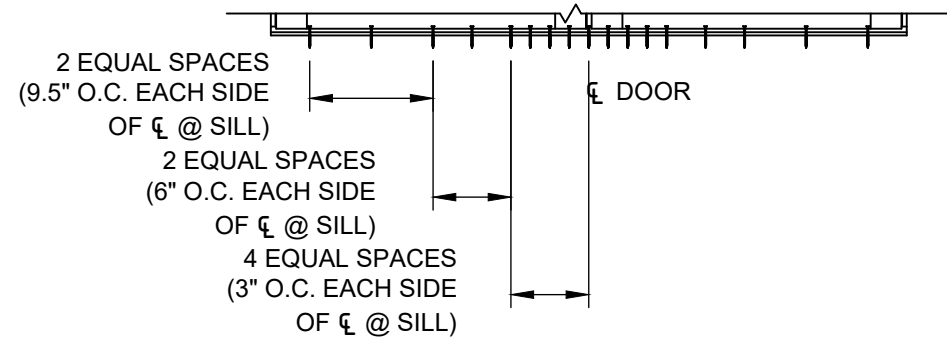

ANCHOR LAYOUT 4
 FOR ALUMINUM THRESHOLD

PROJECT NO. 421-0102	REV	DESCRIPTION	DATE	BY

SIMPSON DOOR COMPANY 400 SIMPSON AVE. MCCLEARY, WA 98557	TITLE: IMPACT 10 FT. OPAQUE WOOD ENTRY DOOR ELEVATION AND ANCHOR LAYOUT	DATE: 6/15/21	DRAWING NO: SIMP00019	SHEET: 5 OF 12
		DRAWN BY: RJA	SCALE: N.T.S.	REV: ---



Robert J. Amoruso, P.E.
 Florida P.E. No. 49752

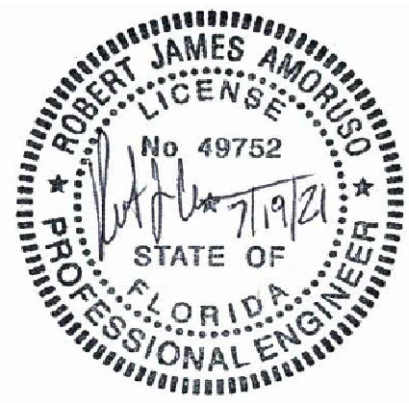

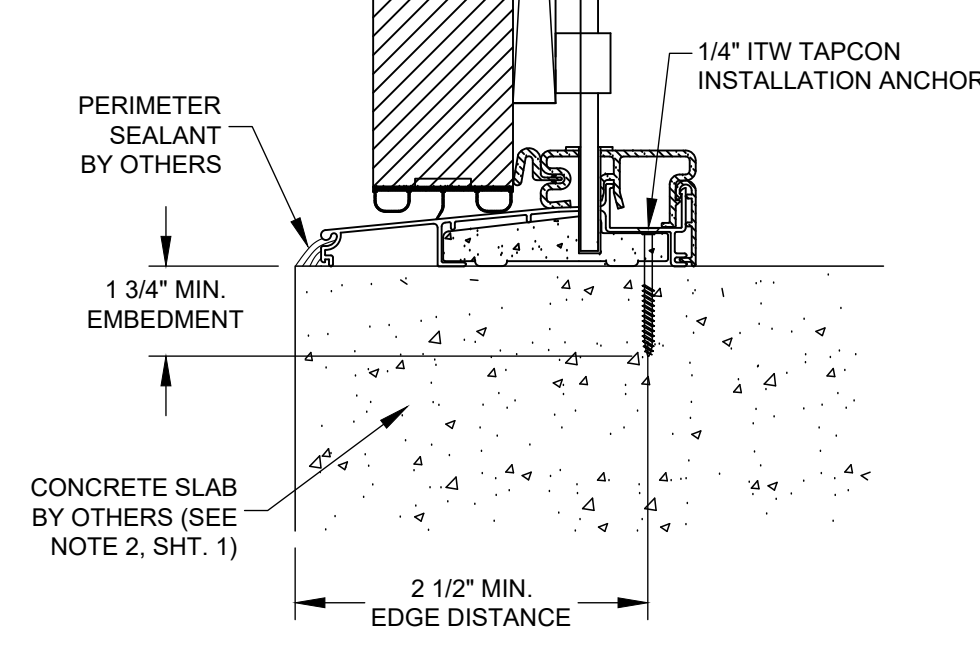
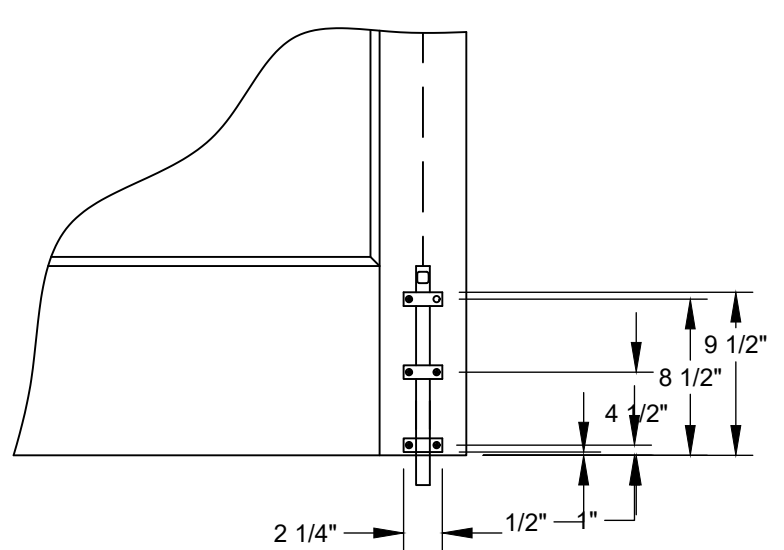
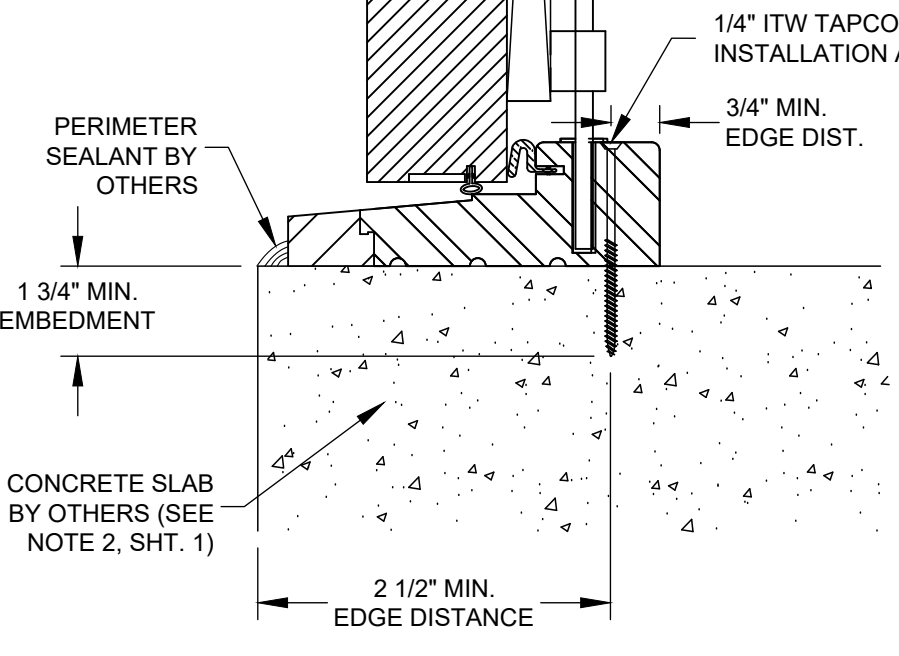
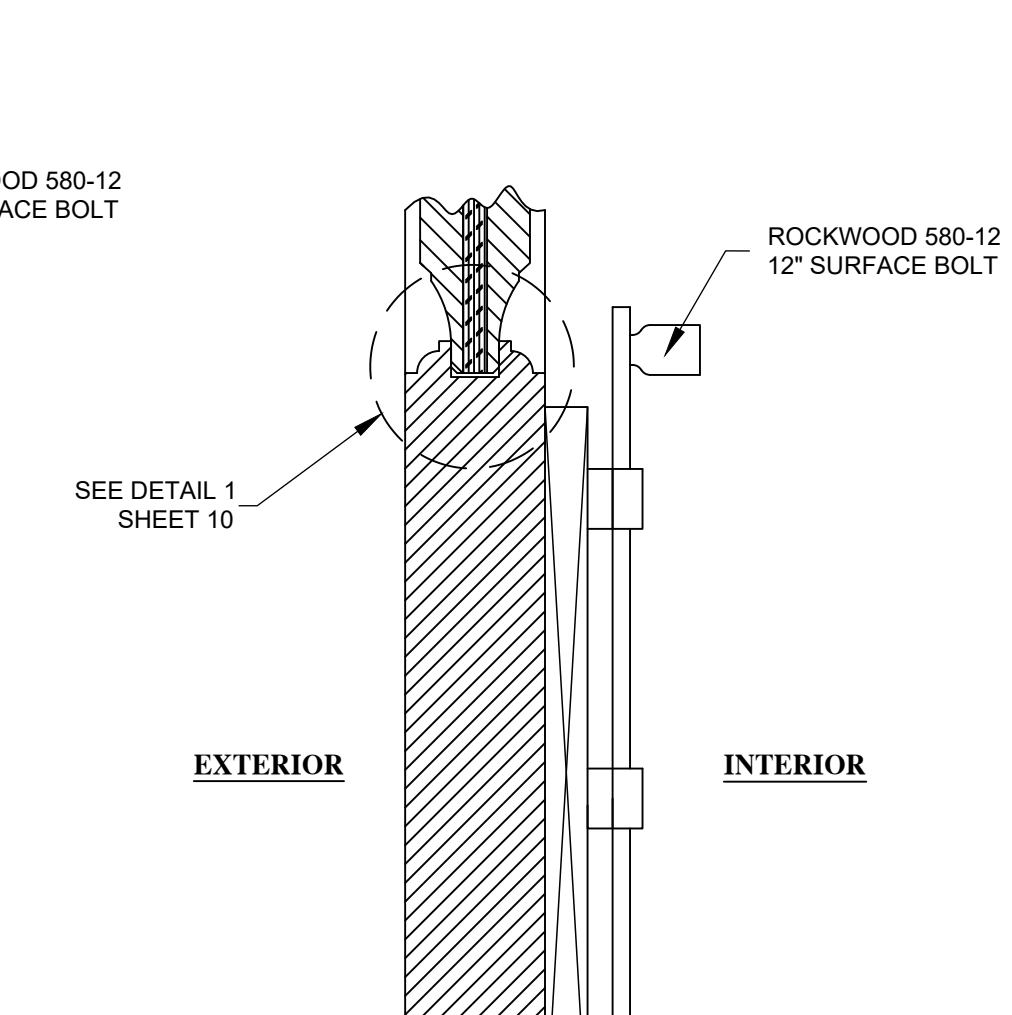
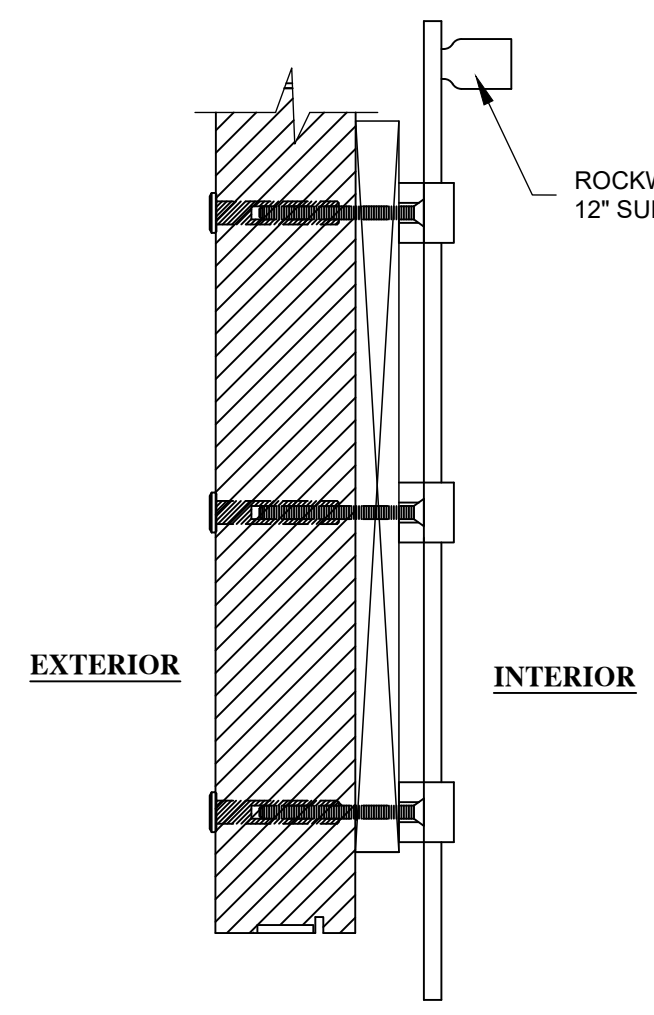
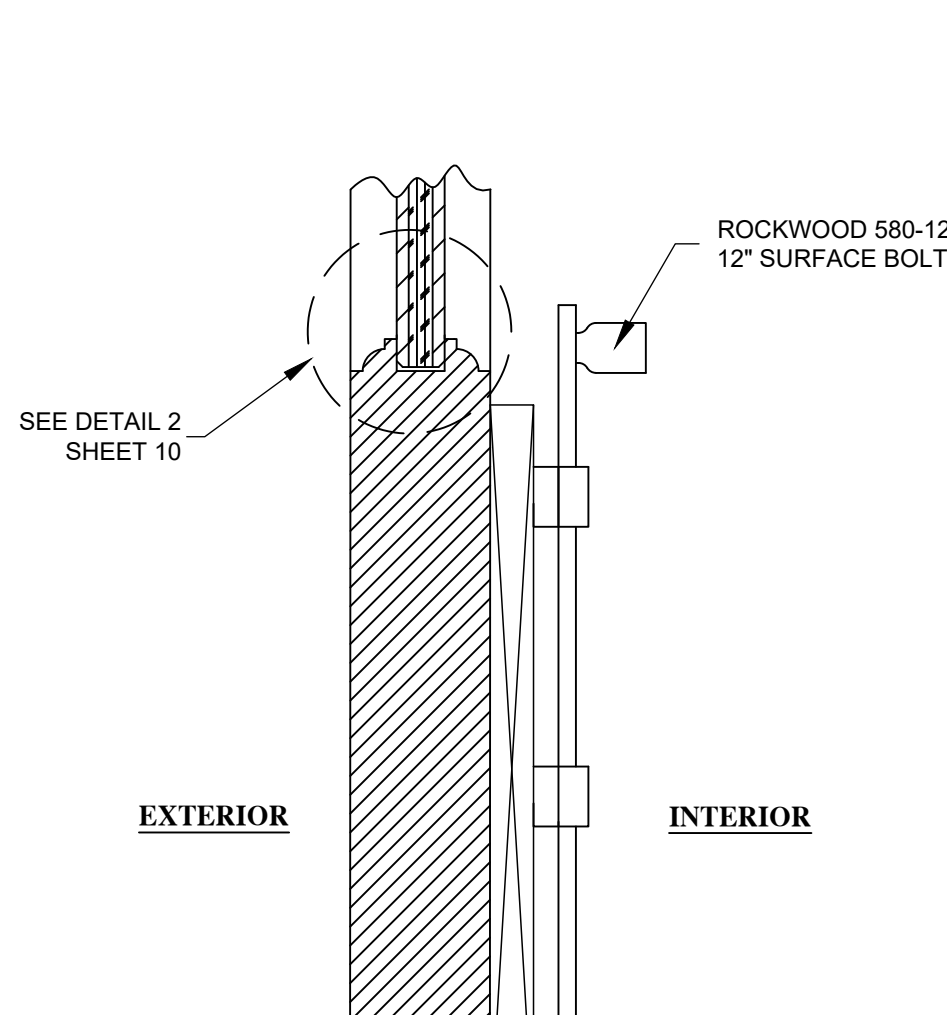

A VERTICAL SECTION
6 CONCRETE SUBSTRATE
 EURO DESIGN

SURFACE BOLT DETAIL
 (TOP IS OPPOSITE)

B VERTICAL SECTION
6 CONCRETE SUBSTRATE
 STANDARD DESIGN

PROJECT NO. 421-0102

REV	DESCRIPTION	DATE	BY

SIMPSON DOOR COMPANY
 400 SIMPSON AVE.
 MCCLEARY, WA 98557

TITLE: IMPACT 10 FT. OPAQUE WOOD ENTRY DOOR
 VERTICAL SECTIONS

PREPARED BY: RJA
 SCALE: N.T.S.
 REV: ---

DATE: 6/15/21
 DRAWING NO: SIMP0019
 SHEET: 6 OF 12

PTC Product Design Group, LLC
 PO Box 320775
 Lombard, IL 60147-0775
 Phone: 321.690.1788
 Fax: 321.690.1789
 Email: info@ptc-corp.com
 FBPE GA. NO. 25595

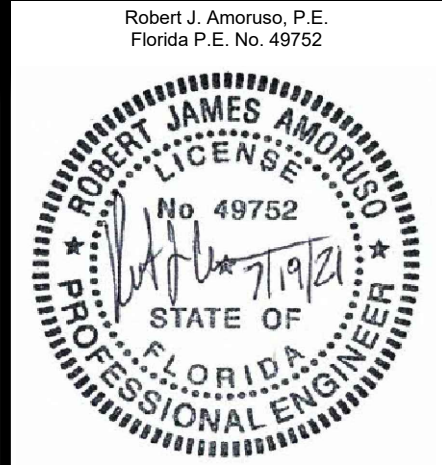

Robert J. Amoruso, P.E.
 Florida P.E. No. 49752

PROJECT NO. 421-0102					

SIMPSON DOOR COMPANY 400 SIMPSON AVE. MCCLEARY, WA 98557		DRAWN BY: RJA SCALE: N.T.S. REV: ---	DATE: 6/15/21 DRAWING NO: SIMP0019 SHEET: 7 OF 12
TITLE: IMPACT 10 FT. OPAQUE WOOD ENTRY DOOR VERTICAL SECTIONS		PREPARED BY: RJA	PHONE: 321.690.1788 FAX: 321.690.1789 LEAD SALES: 321.727.0775 FBPE GA. NO. 25535

Robert J. Amoruso, P.E.
Florida P.E. No. 49752

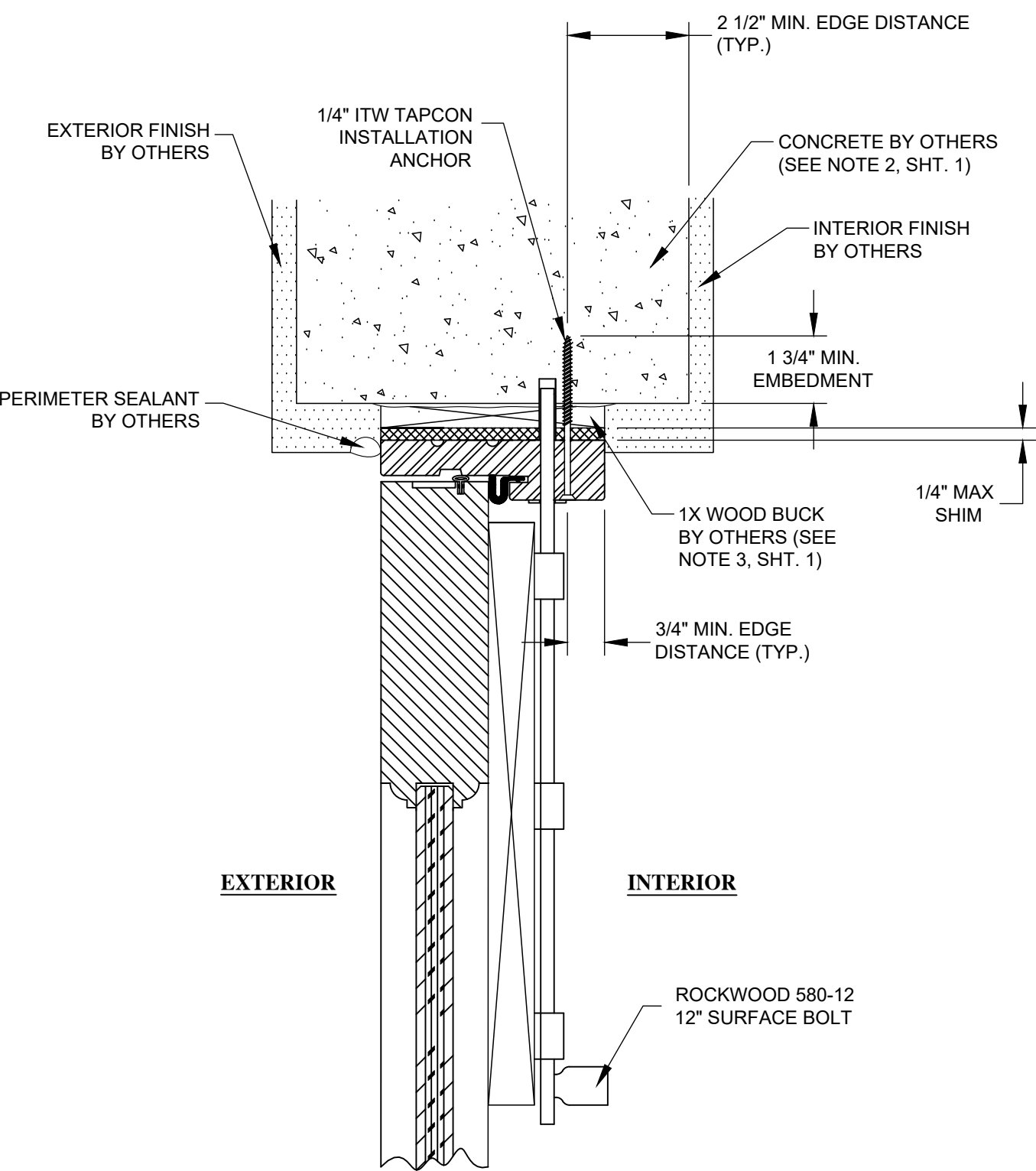
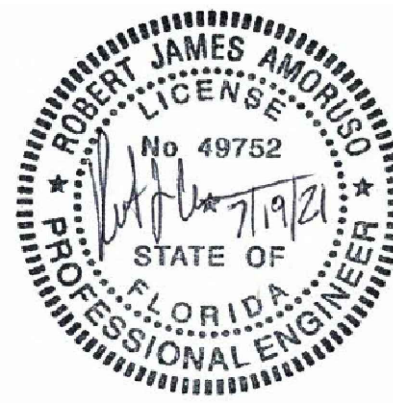

C VERTICAL SECTION
7 CONCRETE SUBSTRATE
EURO DESIGN

(NOTE: SURFACE BOLT USED ON SINGLE ROUND TOP DOOR HAS ONLY TWO (2) FASTENERS.)

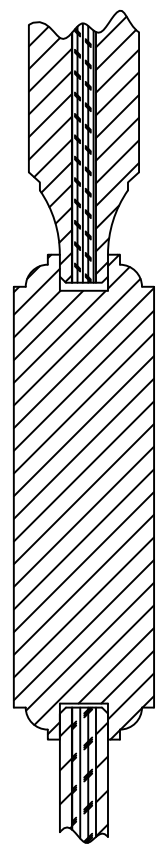

D VERTICAL SECTION
7 INTERMEDIATE RAIL
AND PANEL INSERTS

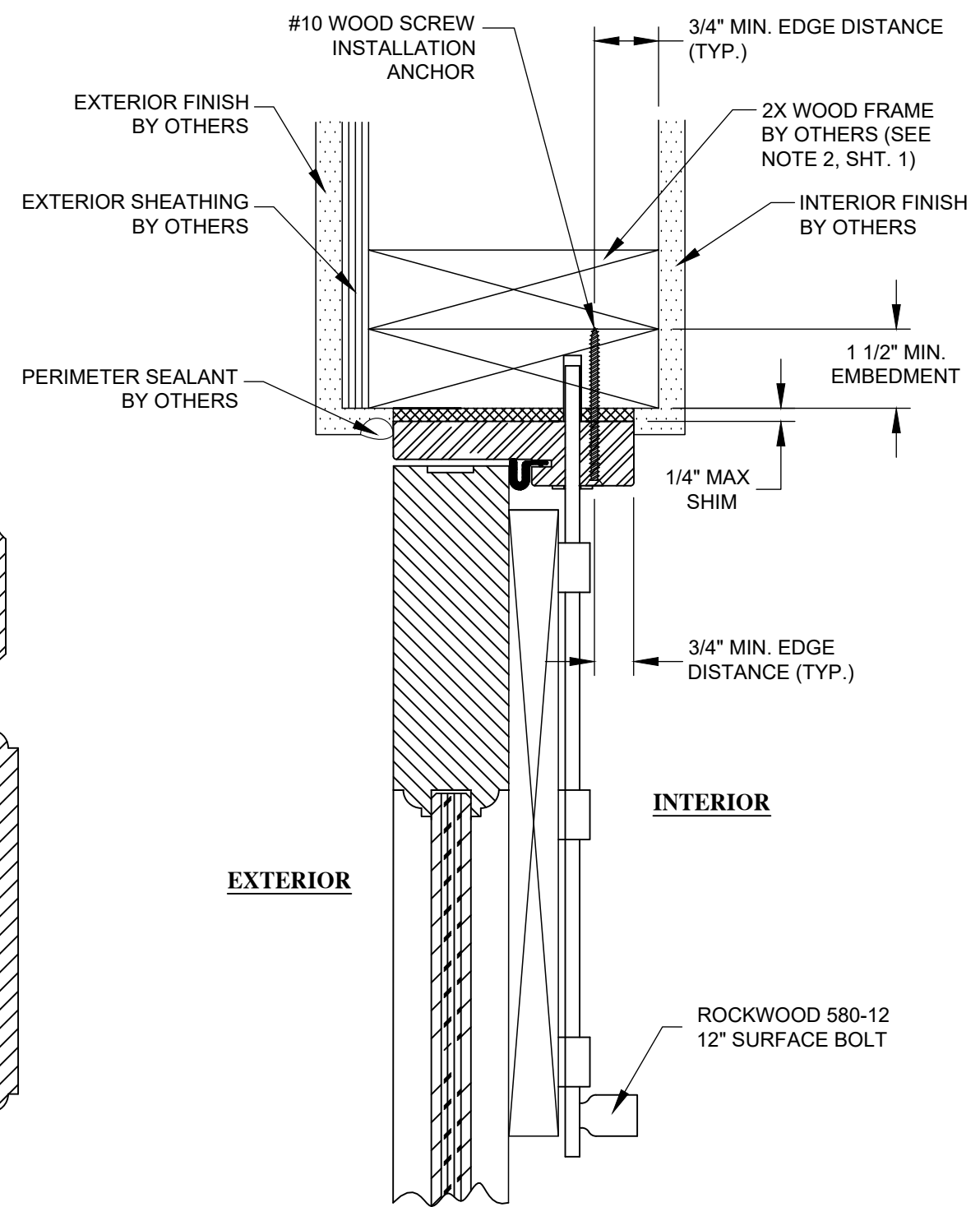

E VERTICAL SECTION
7 WOOD FRAME SUBSTRATE
STANDARD DESIGN

(NOTE: SURFACE BOLT USED ON SINGLE ROUND TOP DOOR HAS ONLY TWO (2) FASTENERS.)

PROJECT NO. 421-0102		REV	DESCRIPTION	DATE	BY

SIMPSON DOOR COMPANY 400 SIMPSON AVE. MCCLEARY, WA 98557		DRAWN BY: RJA	DATE: 6/15/21
TITLE: IMPACT 10 FT. OPAQUE WOOD ENTRY DOOR VERTICAL SECTIONS		SCALE: N.T.S.	DRAWING NO: SIMP0019
PREPARED BY: PC		REV: ---	SHEET: 8 OF 12
P/C Product Design Group, LLC PO Box 320775 Leesville, FL 32073-0775 FBPE GA. NO. 25595		Phone: 321.690.1788	Fax: 321.690.1789
Email: info@pdc-corp.com Email: info@pdc-corp.com			

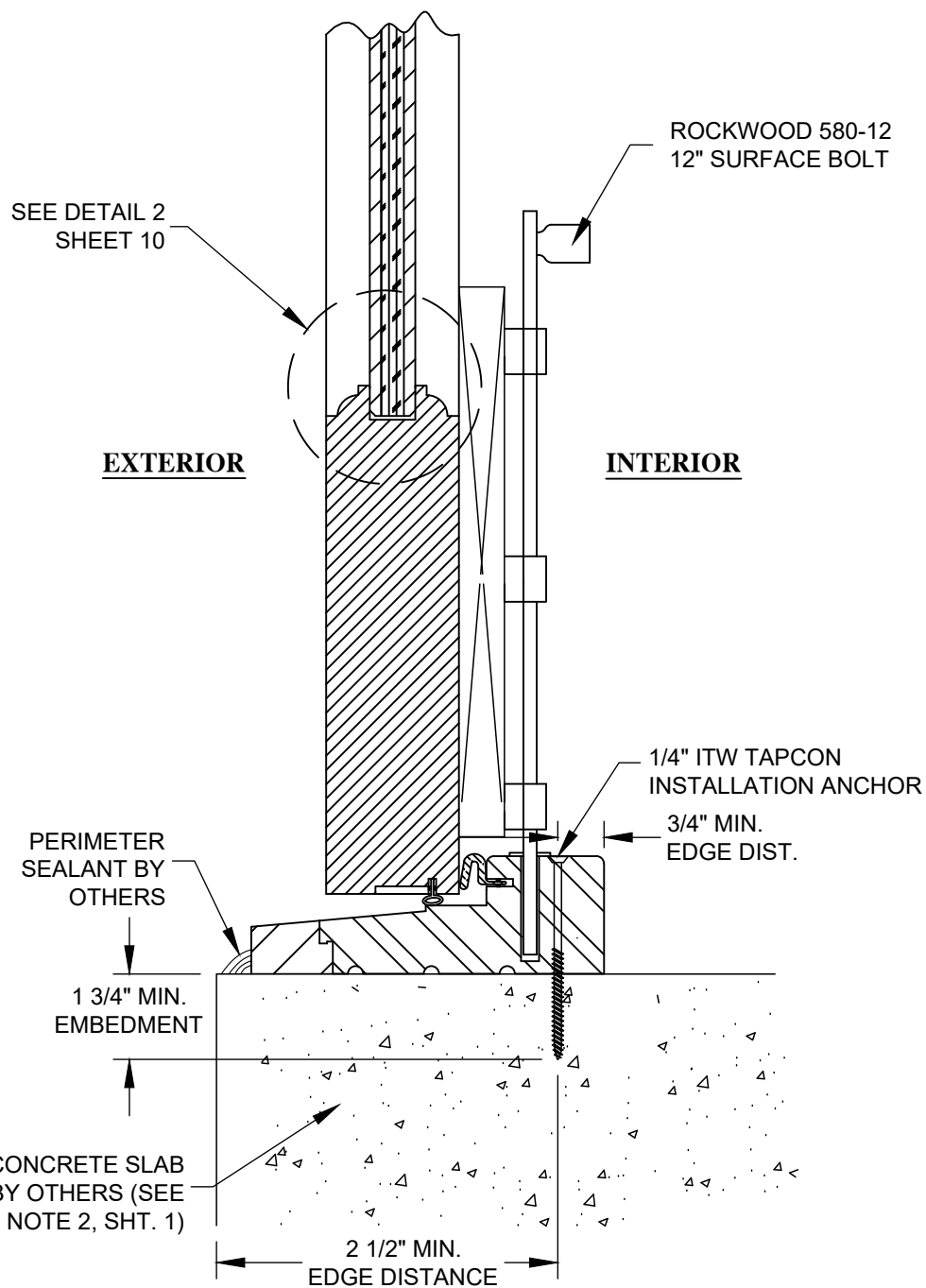

F
8 VERTICAL SECTION
CONCRETE SUBSTRATE
FLAT PANEL OR RAISED PANEL
EURO DESIGN

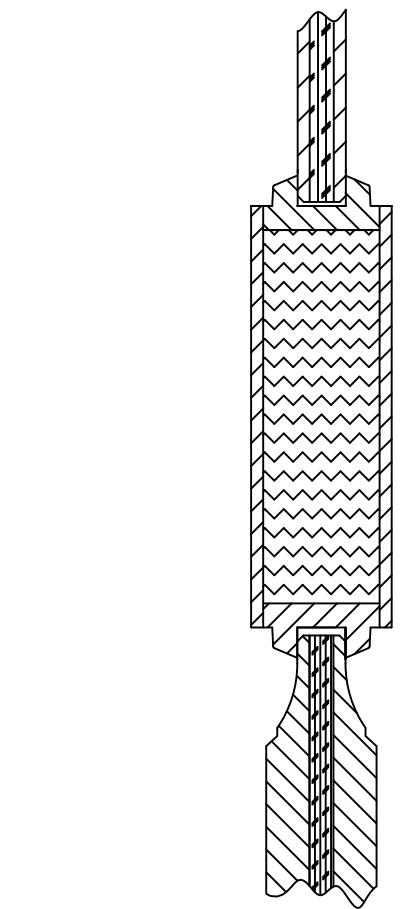

G
8 VERTICAL SECTION
MEETING RAIL
AND PANEL INSERTS

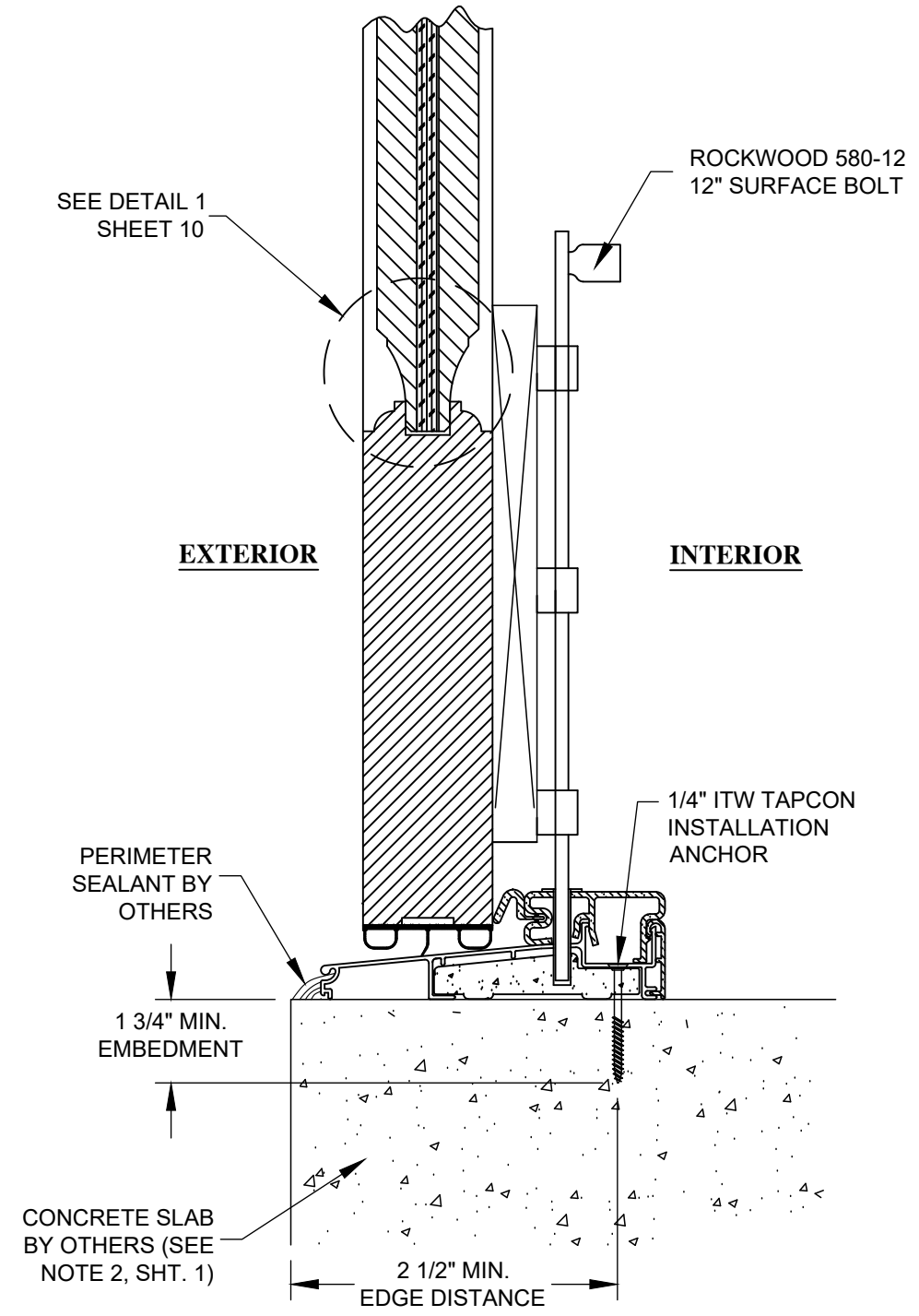

H
8 VERTICAL SECTION
CONCRETE SUBSTRATE
FLAT PANEL OR RAISED PANEL
STANDARD DESIGN

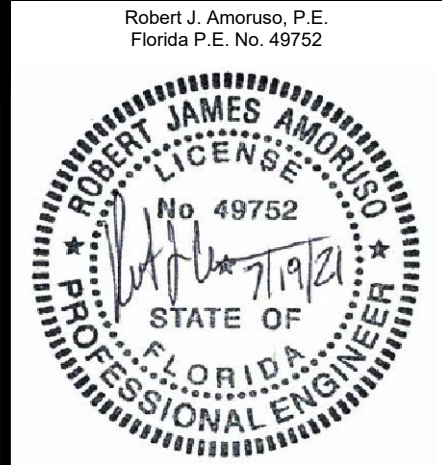

Robert J. Amoroso, P.E.
Florida P.E. No. 49752

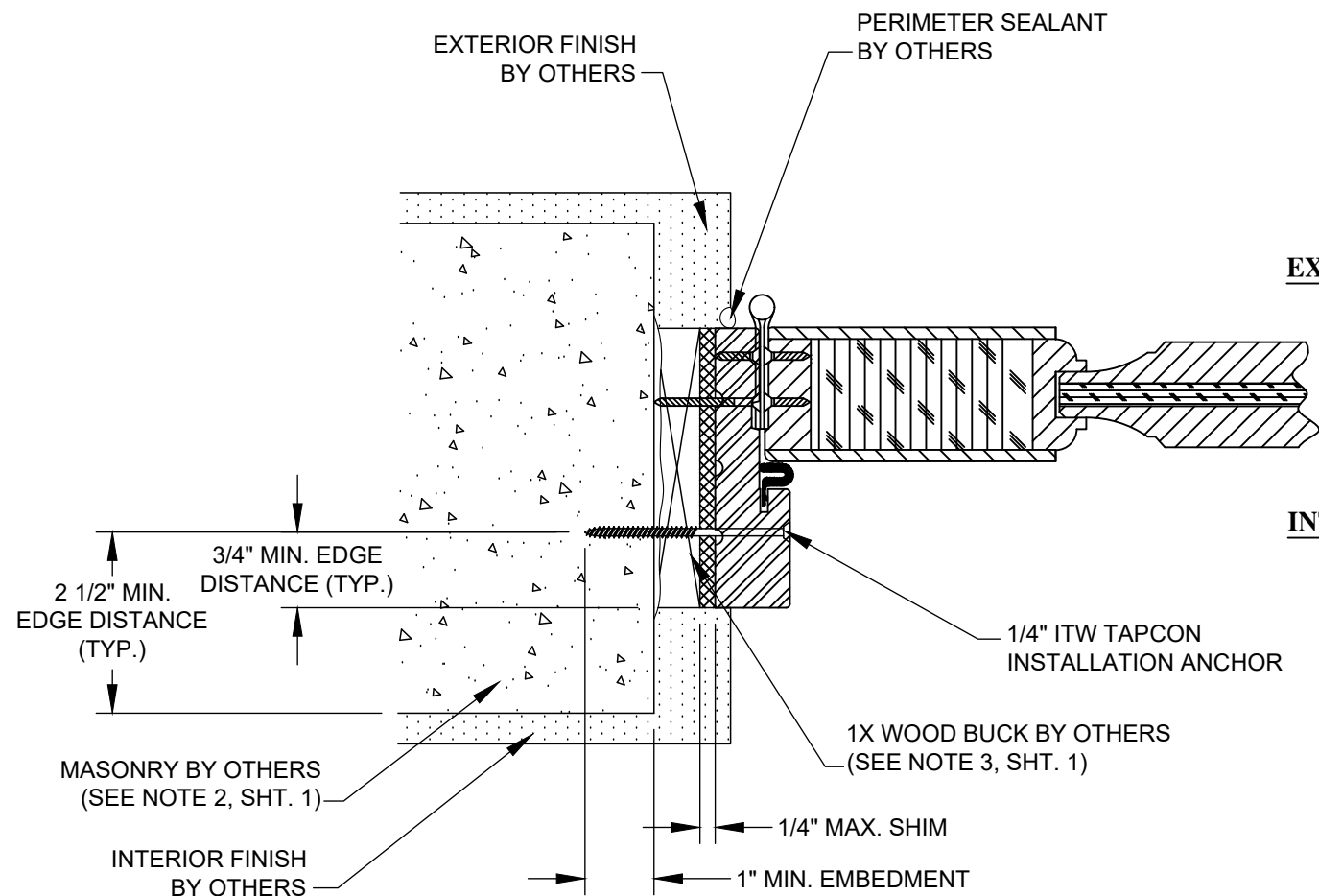

I
9 **HORIZONTAL SECTION**
MASONRY SUBSTRATE
EURO DESIGN JAMB FRAME

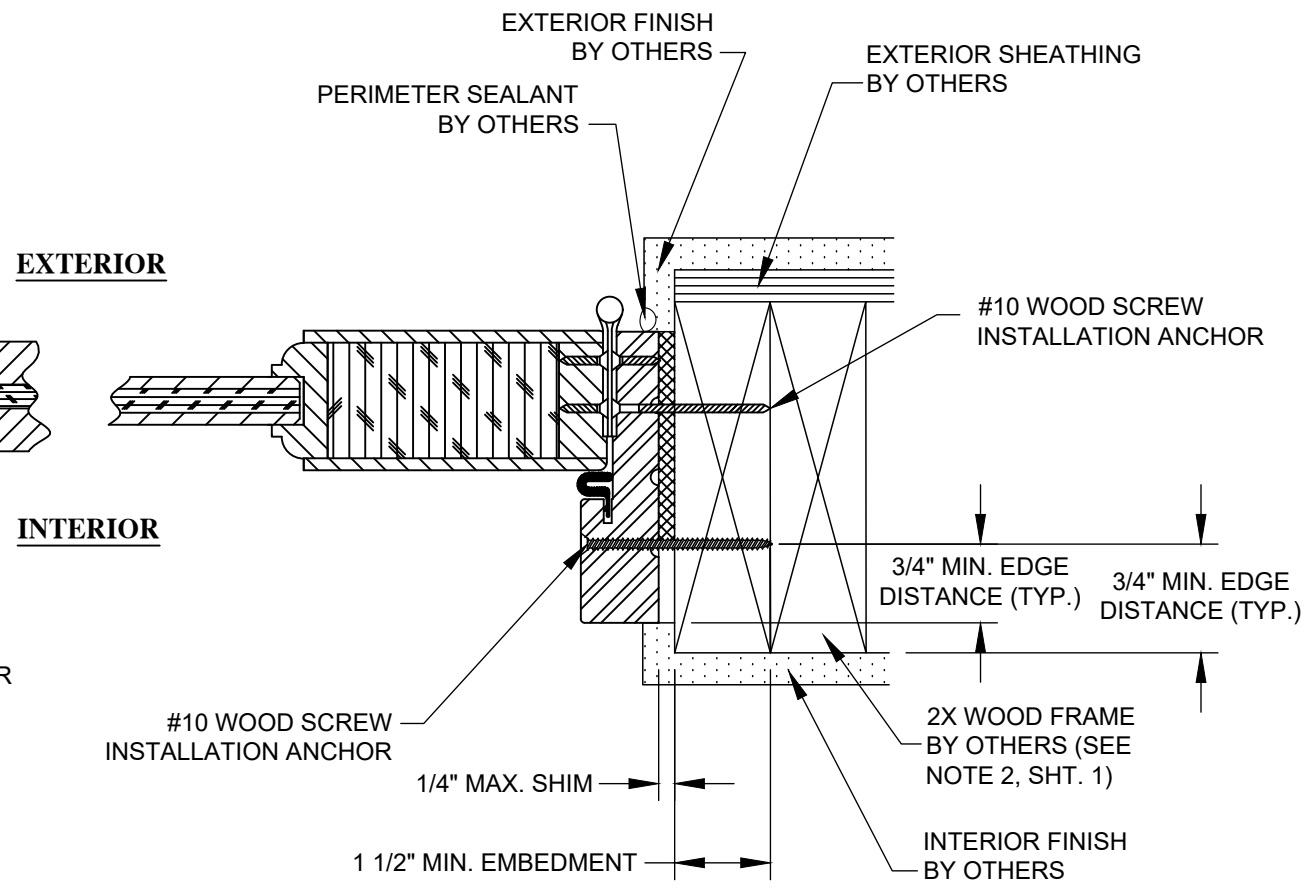

K
9 **HORIZONTAL SECTION**
WOOD FRAME SUBSTRATE
STANDARD DESIGN JAMB FRAME

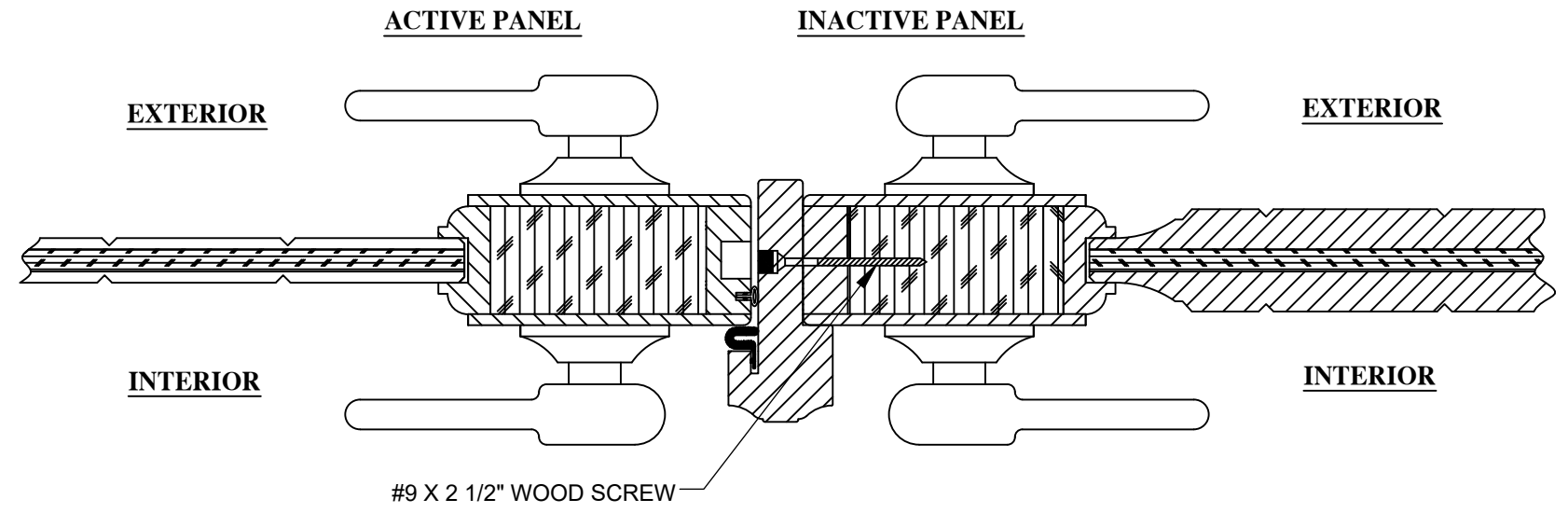

J
9 **HORIZONTAL SECTION**
ASTRAGAL

PROJECT NO. 421-0102		REV	DESCRIPTION	DATE	BY

SIMPSON DOOR COMPANY 400 SIMPSON AVE. MCCLEARY, WA 98557		DRAWN BY: RJA	DATE: 6/15/21
TITLE: IMPACT 10 FT. OPAQUE WOOD ENTRY DOOR HORIZONTAL SECTIONS		SCALE: N.T.S.	DRAWING NO: SIMP0019
PREPARED BY: PTC		REV: ---	SHEET: 9 OF 12
PTC Product Design Group, LLC PO Box 320775 Lubbock, TX 79407-0775 FBPE CA. NO. 25595		Phone: 321.690.1788 Fax: 321.690.1789 Email: info@ptc-corp.com	

Robert J. Amoruso, P.E.
Florida P.E. No. 49752

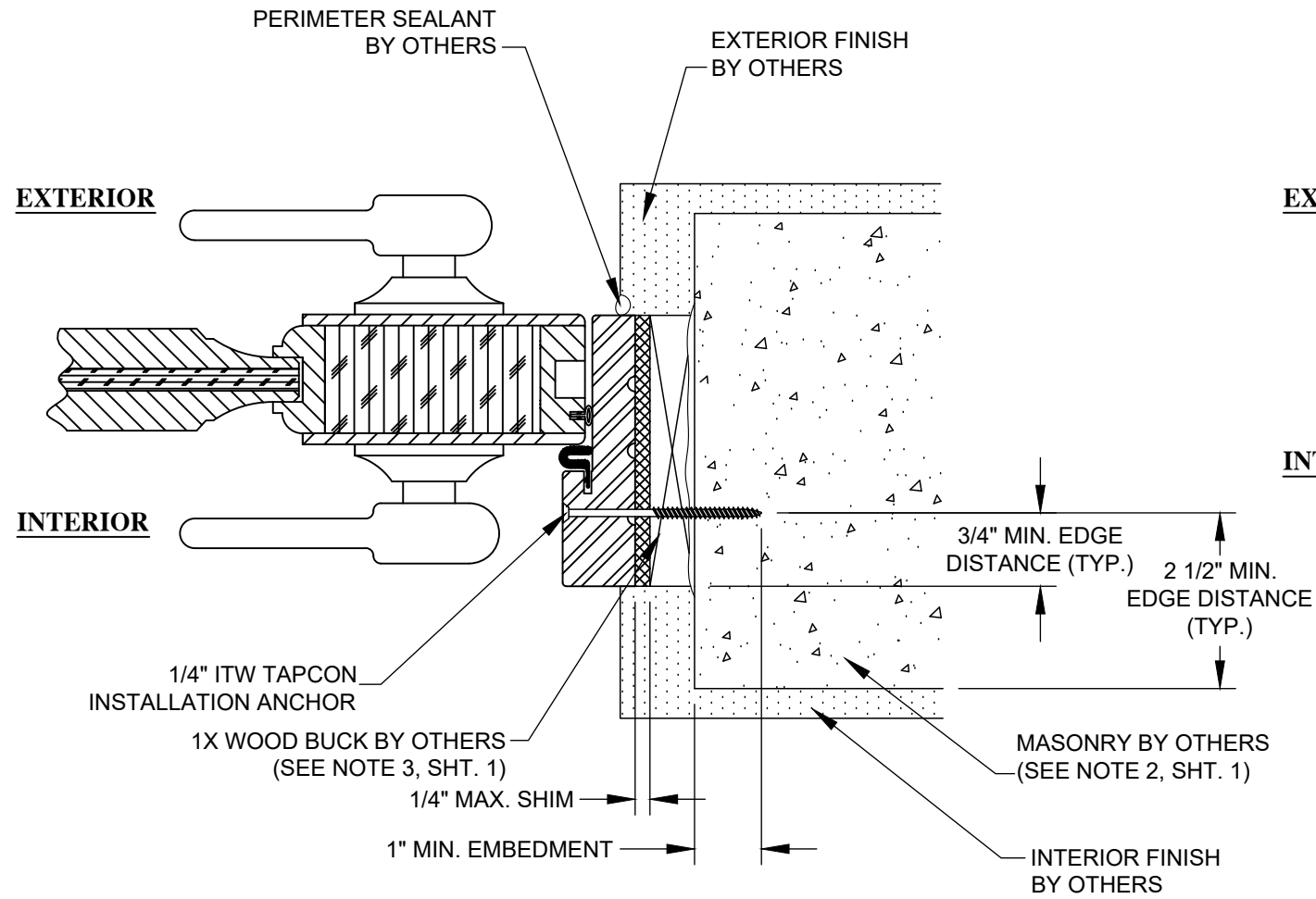

L
10

HORIZONTAL SECTION
MASONRY SUBSTRATE
STANDARD DESIGN JAMB FRAME

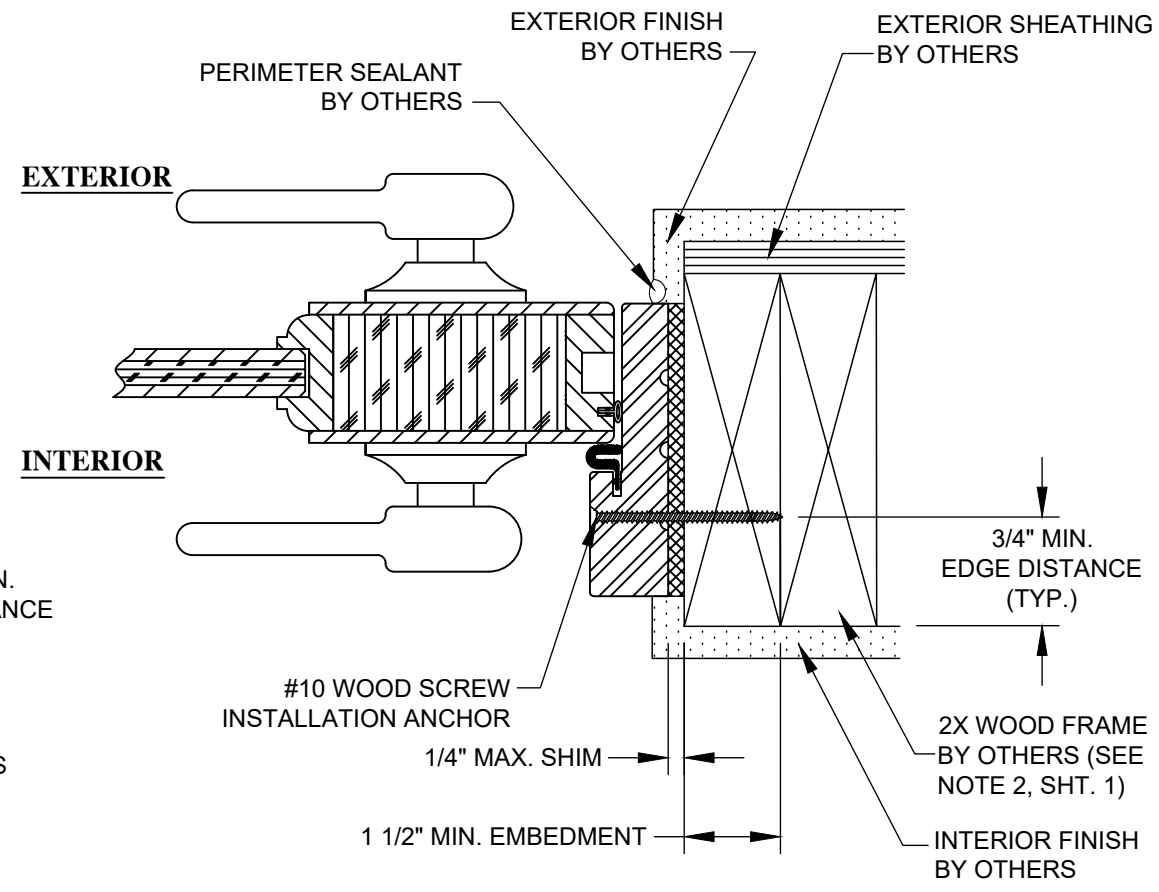

M
10

HORIZONTAL SECTION
WOOD FRAME SUBSTRATE
STANDARD DESIGN JAMB FRAME

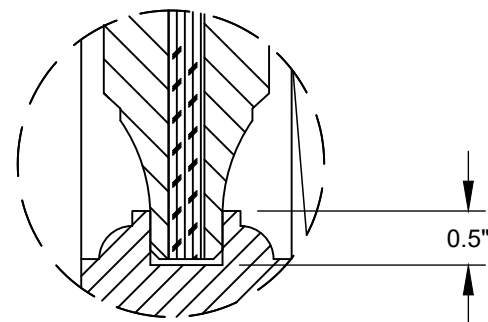

DETAIL 1

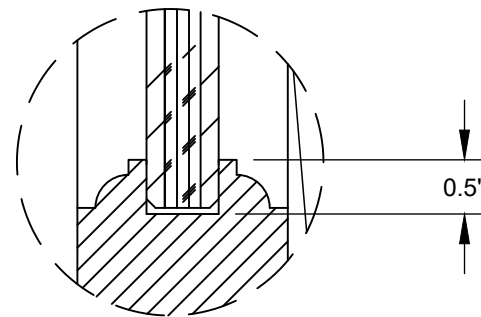

DETAIL 2

PROJECT NO. 421-0102

SIMPSON DOOR COMPANY
400 SIMPSON AVE.
MCCLEARY, WA 98557

TITLE: IMPACT 10 FT. OPAQUE WOOD ENTRY DOOR
HORIZONTAL SECTIONS & PANEL DETAILS

PREPARED BY: RJA
DRAWN BY: RJA
DATE: 6/15/21
SCALE: N.T.S.
DRAWING NO: SIMP0019
SHEET: 10 OF 12

PREPARED BY:
PTC Product Design Group, LLC
PO Box 320775
Lynchburg, VA 24502-0775
FBPE GA. NO. 25595

Robert J. Amoruso, P.E.
Florida P.E. No. 49752

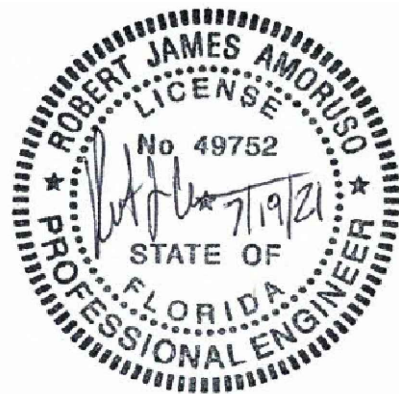

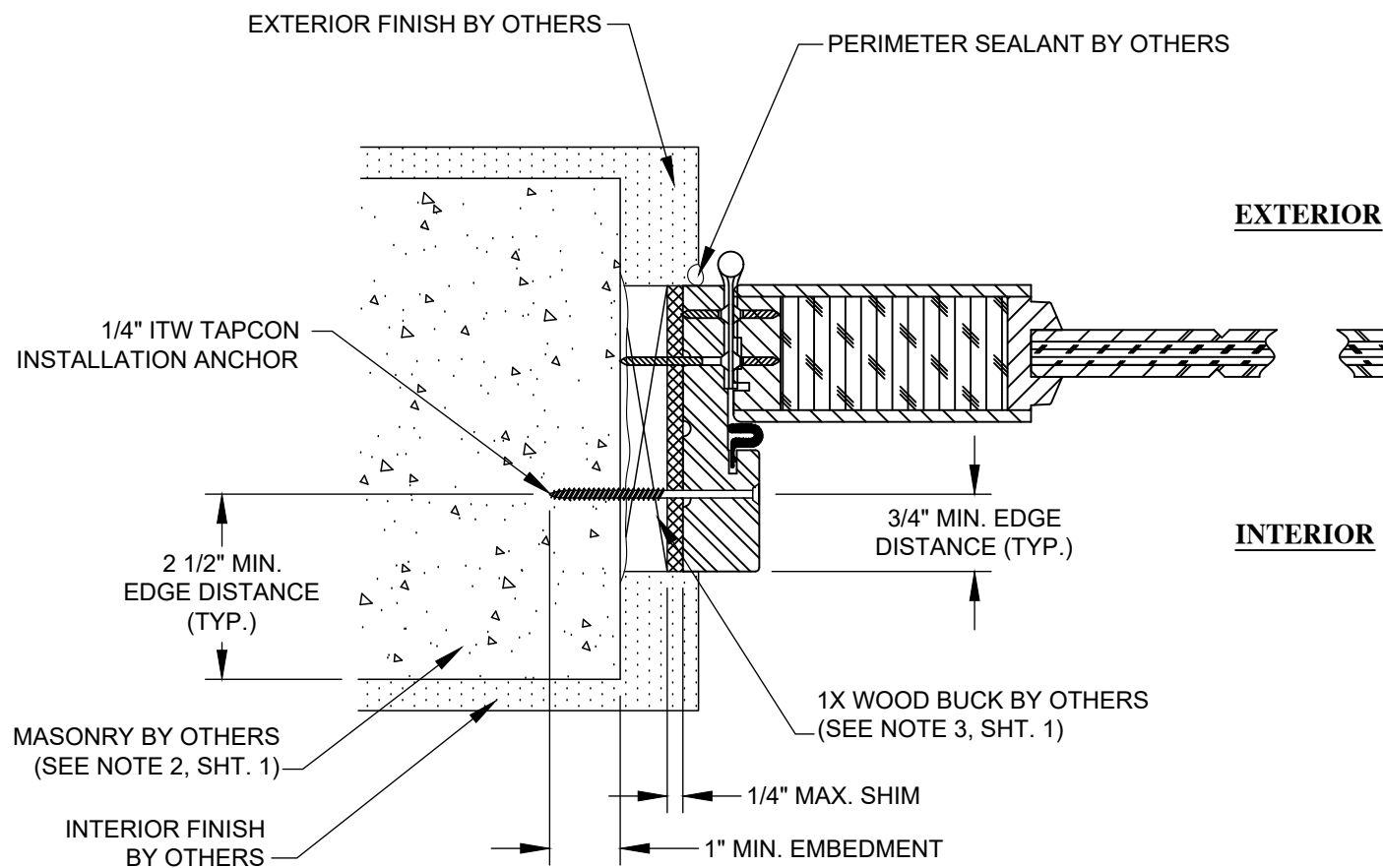

N
11
HORIZONTAL SECTION
MASONRY SUBSTRATE
STANDARD DESIGN JAMB FRAME

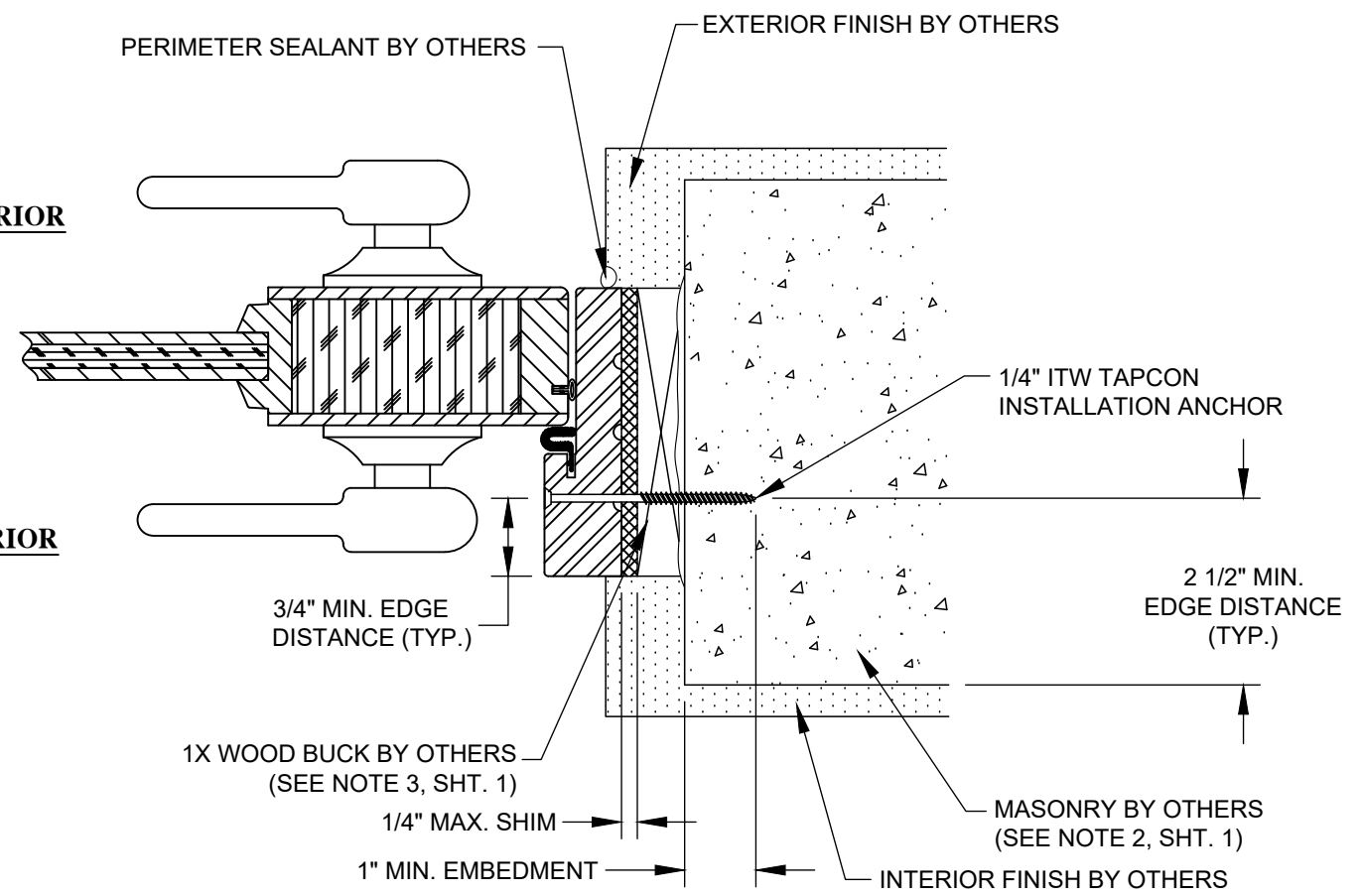

O
11
HORIZONTAL SECTION
MASONRY SUBSTRATE
STANDARD DESIGN JAMB FRAME

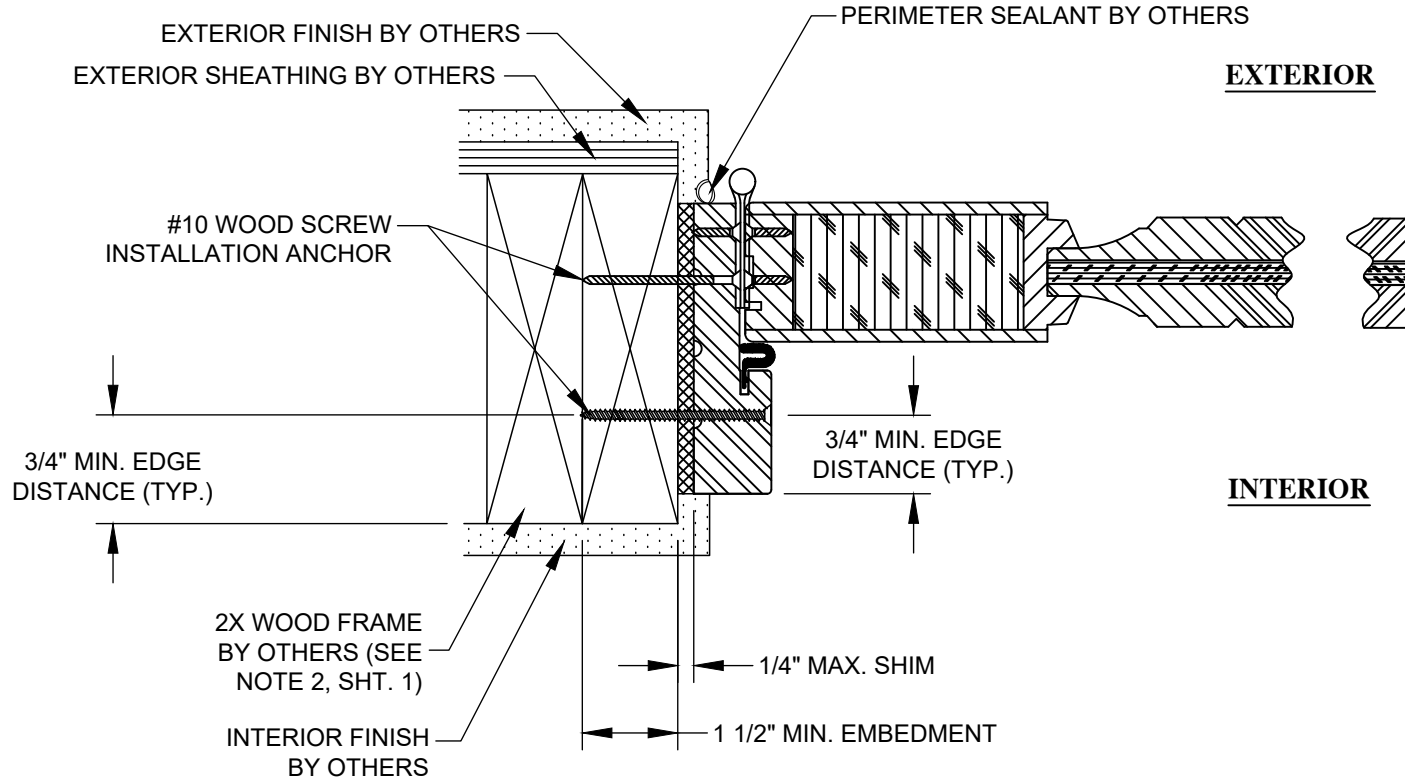

P
11
HORIZONTAL SECTION
WOOD FRAME SUBSTRATE
STANDARD DESIGN JAMB FRAME

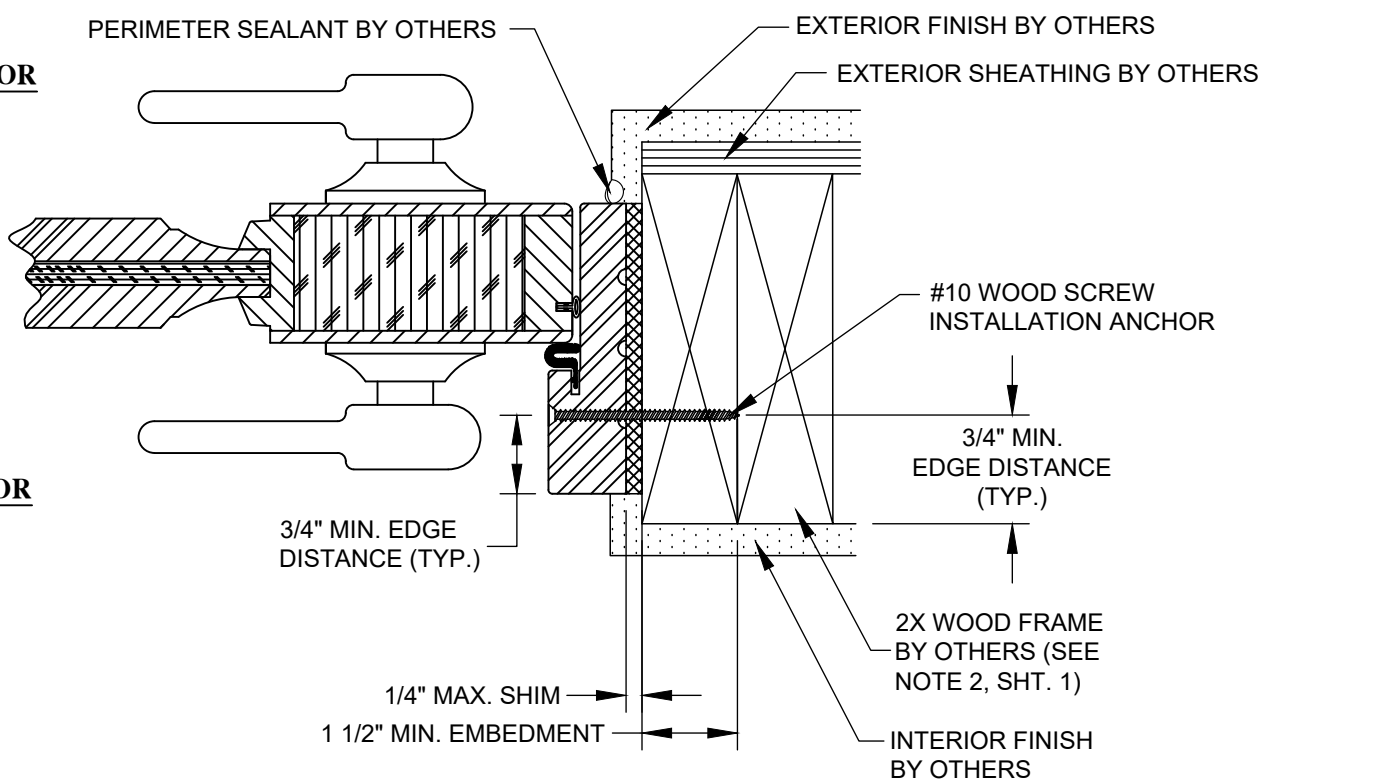

Q
11
HORIZONTAL SECTION
WOOD FRAME SUBSTRATE
STANDARD DESIGN JAMB FRAME

PROJECT NO. 421-0102						

SIMPSON DOOR COMPANY 400 SIMPSON AVE. MCCLEARY, WA 98557		DRAWN BY: RJA		DATE: 6/15/21
TITLE: IMPACT 10 FT. OPAQUE WOOD ENTRY DOOR HORIZONTAL SECTIONS		SCALE: N.T.S.	DRAWING NO: SIMP0019	REV: ---
PREPARED BY: FFE		PHONE: 321.690.1788	FAX: 321.690.1789	EMAIL: info@pdc-corp.com
		PO BOX 320775	LEWISTON, FL 32072-0775	FBPE GA. NO. 25585
		SHEET: 11 OF 12		DESCRIPTION
				DATE
				BY

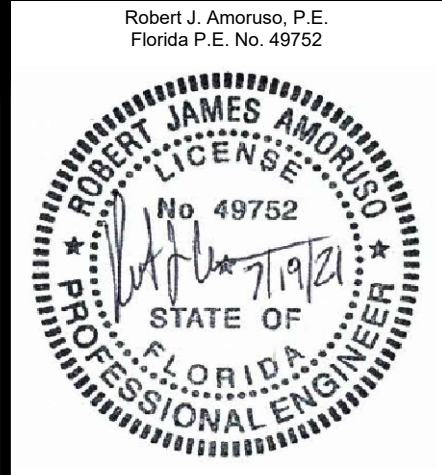

Robert J. Amoruso, P.E.
Florida P.E. No. 49752

* ALL ELEVATIONS SHOWN ALSO QUALIFY 96", 84", AND 80" HEIGHTS AND ANY OTHER CUSTOM SIZES SMALLER THAN TESTED.

48" MAX. WIDTH
120" MAX. HEIGHT

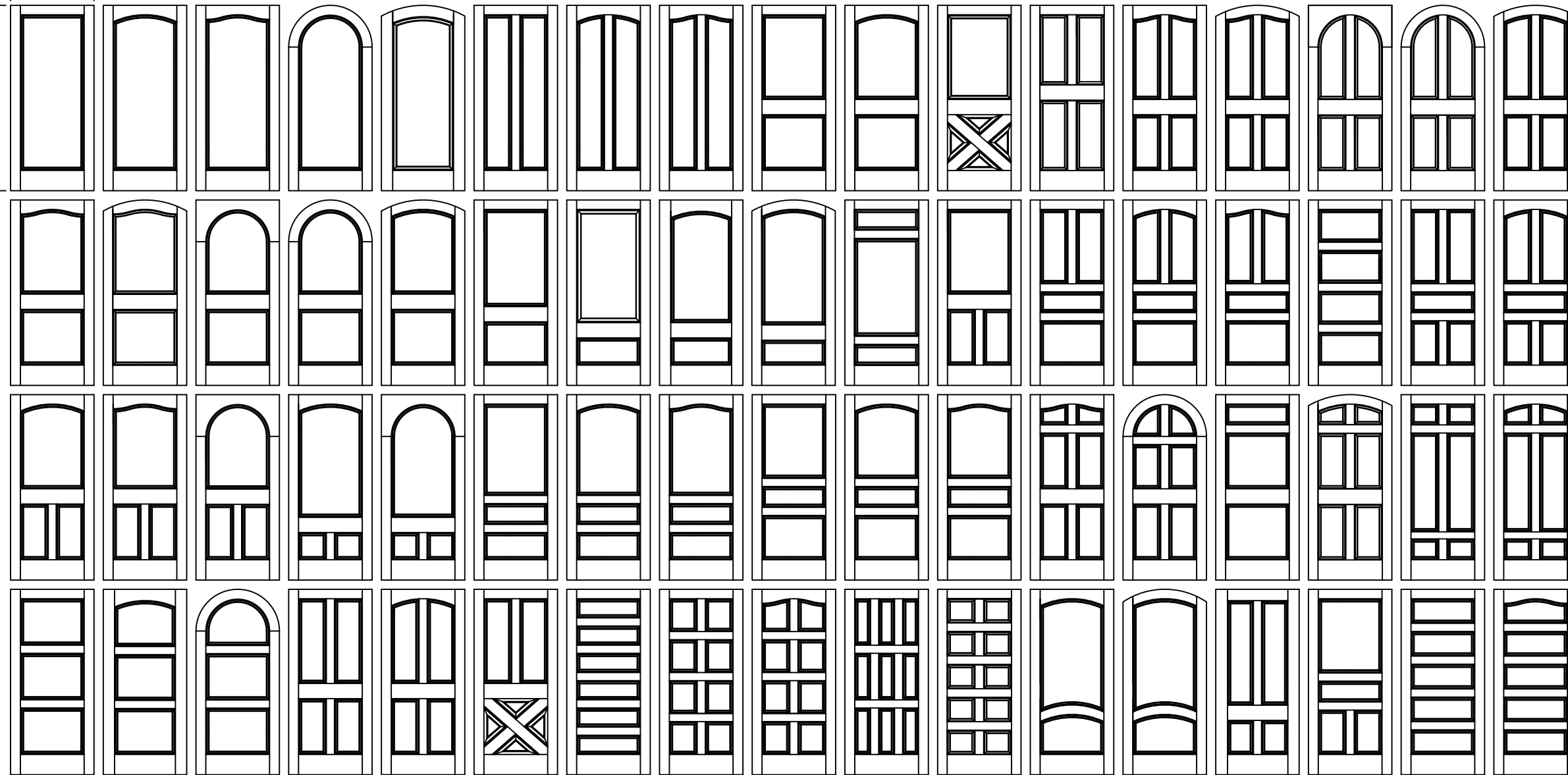

NOTE: DOOR PANELS MAY BE RECTANGULAR, ARCH, OR ROUND TOP.

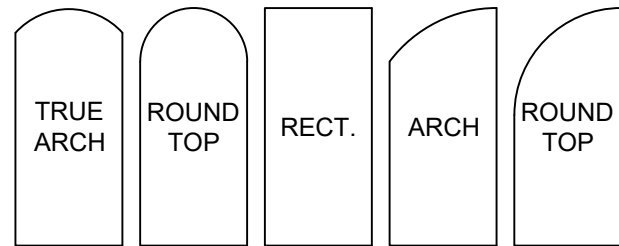

APPLICABLE PANELED PANEL DOORS

NOTE:
V-GROOVES OPTIONAL FOR BOTH
FLAT AND RAISED PANELS

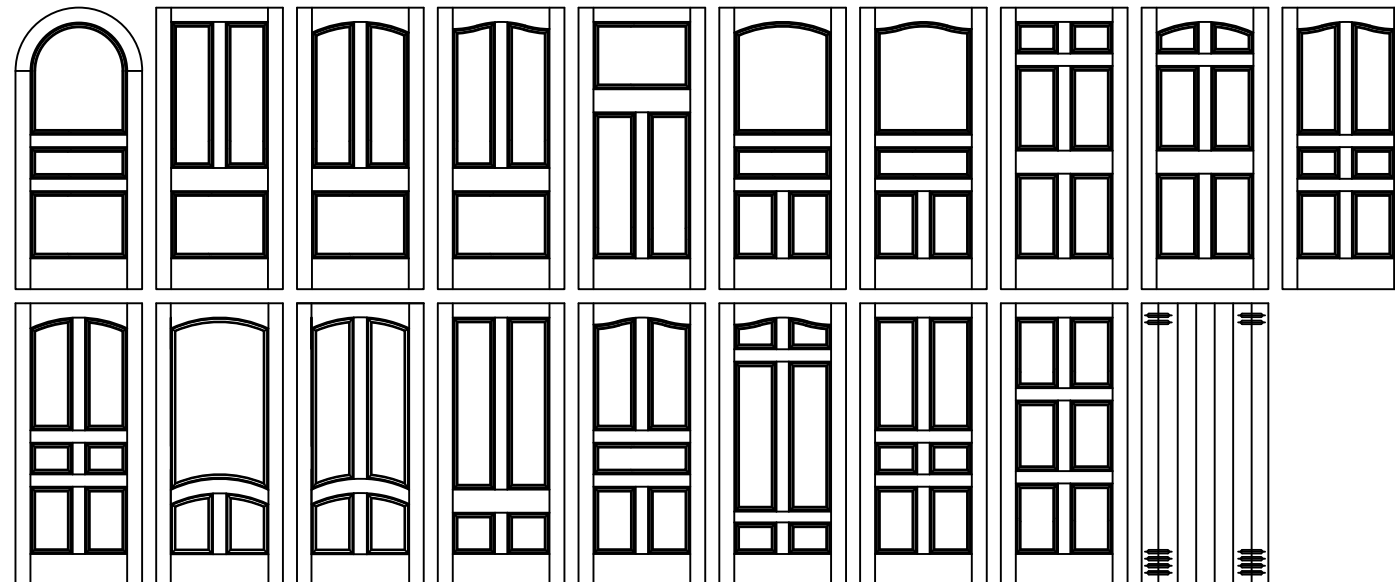

SIMPSON DOOR COMPANY
400 SIMPSON AVE.
MCCLEARY, WA 98557

TITLE: IMPACT 10 FT. OPAQUE WOOD ENTRY DOOR CONFIGURATIONS

PREPARED BY: RJA
DRAWN BY: RJA
DATE: 6/15/21
SCALE: N.T.S.
DRAWING NO: SIMP0019
REV: ---
SHEET: 12 OF 12

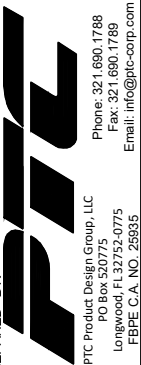

Robert J. Amoruso, P.E.
Florida P.E. No. 49752

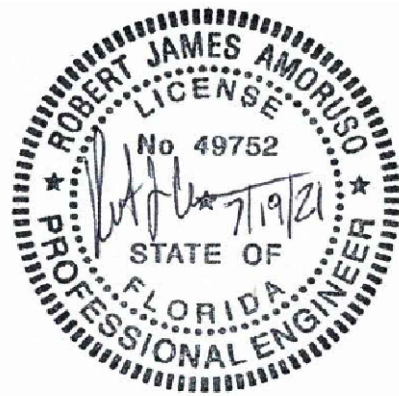

PROJECT NO. 421-0102

REV	DESCRIPTION	DATE	BY